

*Presented to McLaughlin Memorial Library
by Isabelle Pursel, 1981*

THE FREDRICK FOLKS
(Elias and Mary)

Ancestors, Descendants
and
"Kissin' Kin"

Compiled by
Isabelle Pursel
May, 1981

Isabelle Pursel

MCLAUGHLIN MEMORIAL PUBLIC
LIBRARY

ARCHBOLD, OHIO 43502 28996

TABLE OF CONTENTS

Elias and Mary Fredrick	Pages 3-5
Ancestors of Elias	6-7
Ancestors of Mary	8-16
Descendants of Elias and Mary:	
I. Daniel	17-39
Emerson	20-27
Lovelle	28-29
Mary	30-37
Isabelle	38-39
II. Charles	40-46
Lloyd	42-43
Walter	44-46

FAMILY GROUP No. Husband's Full Name FREDRICK, Elias

This Information Obtained From:		Husband's Data	Day	Month	Year	City, Town or Place	County or Province, etc.	State or Country	Add. Info. on Husband
	Birth	31	Aug	1850	York Twp	Fulton	OH		
	Chr'nd								
	Mar.	27	Feb	1879	Reiffsburg	Wells	IN		
	Death	21	Aug	1921	Delta	Fulton	OH		
	Burial				Zion Cem, York Twp	Fulton	OH		
Places of Residence									
Occupation			Church Affiliation				Military Rec.		
Other wives, if any. No. (1) (2) etc. Make separate sheet for each mar.									
His Father John Fred(e)rick					Mother's Maiden Name Catharine Leist				

Wife's Full Maiden Name SHOEMAKER, Mary

Wife's Data		Day	Month	Year	City, Town or Place	County or Province, etc.	State or Country	Add. Info. on Wife
	Birth	6	Aug	1860	near Geneva	Adams	IN	
	Chr'nd							
	Death	26	Nov	1942	Wauseon	Fulton	OH	
	Burial	29	Nov	1942	Zion Cem, York Twp	Fulton	OH	
Compiler Isabelle Pursel								
Places of Residence								
Address 505 Brussel St.			Occupation if other than Housewife			Church Affiliation		
City, State Archbold, OH								
Other husbands, if any. No. (1) (2) etc. Make separate sheet for each mar.								
Date May, 1981		Her Father Henry B. Shoemaker			Mother's Maiden Name Sarah Pontius			

Sex	Children's Names in Full (Arrange in order of birth)	Children's Data	Day	Month	Year	City, Town or Place	County or Province, etc.	State or Country	Add. Info. on Child
1	John Henry Full Name of Spouse*	Birth	28	Jul	1880	York Twp.	Fulton	OH	
		Mar.							
		Death	23	Dec	1881	York Twp.	Fulton	OH	
		Burial				Zion Cem, York Twp.	Fulton	OH	
2	Daniel Elias Full Name of Spouse*	Birth							
		Mar.				See his family group sheet	p. 17		
		Death							
		Burial							
3	Charles Roswell Full Name of Spouse*	Birth							
		Mar.				See his family group sheet	p. 40		
		Death							
		Burial							
4	Full Name of Spouse*	Birth							
		Mar.							
		Death							
		Burial							
5	Full Name of Spouse*	Birth							
		Mar.							
		Death							
		Burial							
6	Full Name of Spouse*	Birth							
		Mar.							
		Death							
		Burial							
7	Full Name of Spouse*	Birth							
		Mar.							
		Death							
		Burial							
8	Full Name of Spouse*	Birth							
		Mar.							
		Death							
		Burial							
9	Full Name of Spouse*	Birth							
		Mar.							
		Death							
		Burial							
10		Birth							
		Mar.							

ELIAS AND MARY FREDRICK

Elias Fredrick was born 31 Aug 1850 to John and Catharine (Leist) Fred(e)-rick in Section 10 of York Twp. Fulton Co. OH. Mary Shoemaker was born 6 Aug 1860 in Adams Co. IN near Geneva to Henry Braucher and Sarah E. (Pontius) Shoemaker. Before she was a year old, her mother died. While a girl, she attended the Union District School in Adams Co. and the old Hartford Sunday School and church. In 1877, she moved with her parents to Reiffsburg, Wells Co., IN. Before her marriage she worked out as a hired girl.

Elias and Mary were married in the home of her parents in Wells Co. IN 27 Feb 1879 by Rev. Jacob McLin of Geneva. Elias was a farmer, and their farm was in Section 2 of York Twp. Fulton Co. OH on the East side of Road 9. It was 40 A. in the SW corner of the NW quarter of the Section. They lived in a log house before another home was built SW of it. Lightning hit and destroyed their barn once and another was built. Here three sons were born: John Henry, 28 Jul 1880, Daniel Elias 15 Jan 1883, and Charles Roswell 29 Sep 1887. John Henry, named after both grandfathers, died 23 Dec. 1881, ly 4m 25d, of membranous croup. They were members of the Hebron Christian Union Church.

The exact time that they moved to Delta has not been determined. A note in Mary's handwriting states: "Elias Fredrick sold his house November 28, 1917 and bought in Delta November 30, 1917. Mrs. Elias Fredrick". The Warranty Deed from Charles L. Ives to Elias Fredrick and Mary Fredrick for Lots Nine (9) and Ten (10) in Pray's Second Addition to the Village of Delta is dated March 8, 1918. This location is 614 Fernwood. The upstairs was not completed when they purchased it. Elias died here 21 Aug 1921, 70y 11m 20d. Death certificate lists cause as heart dilatation. His funeral was held 25 Aug 1921 at Zion United Brethren Church with Rev. Marshall Gray of Newark, OH (a friend in the Christian Union Church) officiating, and assisted by Rev. R. V. Gilbert, United Brethren minister of Delta. He is buried in the cemetery by the church, formerly Gould Cemetery, now Zion Cemetery.

Mary continued to live alone, earning money by providing room and board for men, and with a rental property on Jefferson St. She joined and attended the Traill Chapel United Brethren Church three blocks from her home. In the fall of 1942, while at a family reunion at her sister Emma's near Uniondale, IN, she fell, fracturing her femur bone. She died at Detwiler Hospital, Wauseon, OH 26 Nov 1942, 82y 6m 20d. Her funeral was conducted 29 Nov 1942 at the Traill Chapel United Brethren Church by Rev. Walter Throop and Rev. J. G. Connor, both United Brethren ministers. She is buried in Zion Cemetery.

ORCHARD
Paul Shoemaker made me a swing here one summer. X

THE ELIAS FREDRICK FARM
as remembered by
Emerson Fredrick

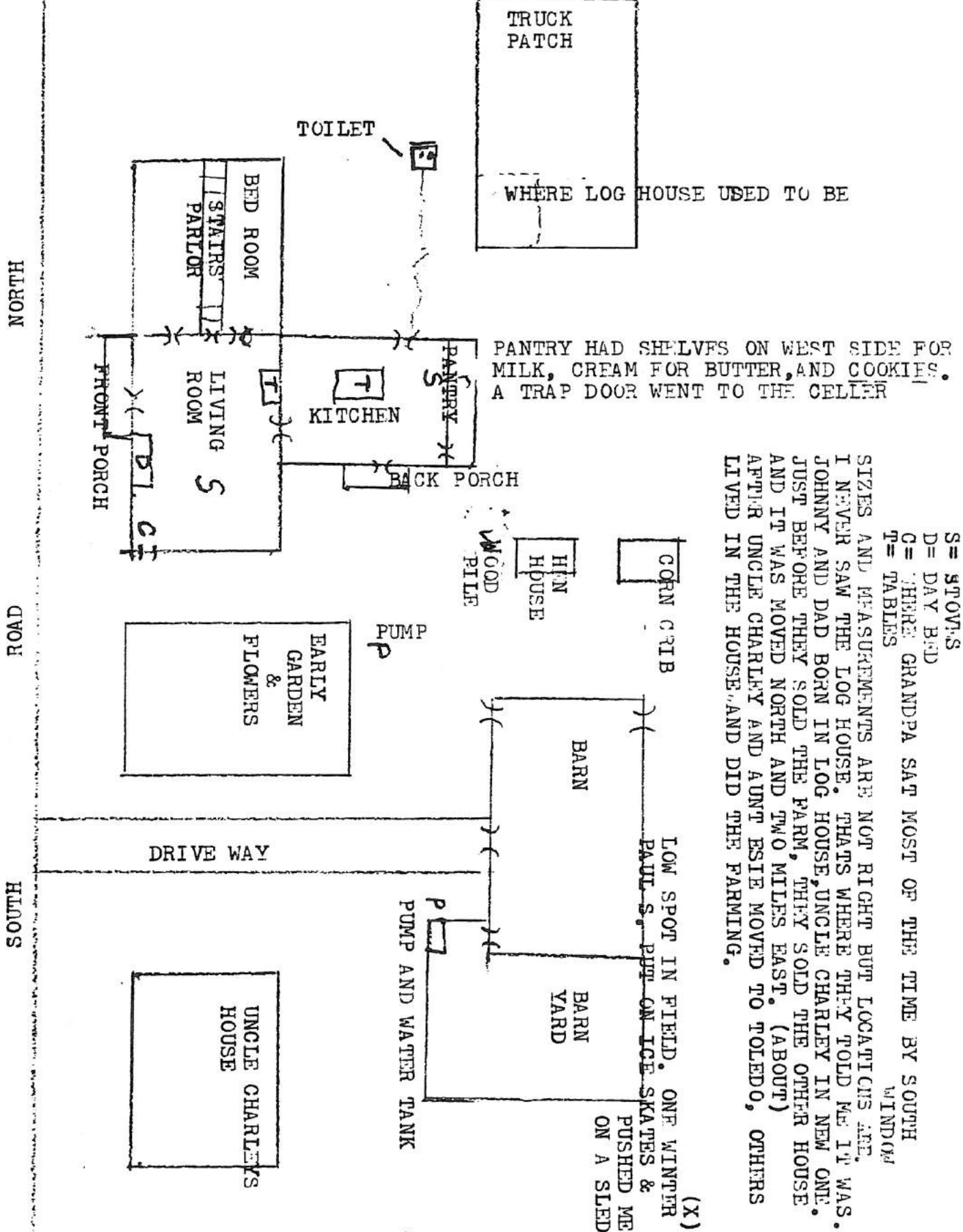

S = STOVE
D = DAY BED
C = WHERE GRANDPA SAT MOST OF THE TIME BY SOUTH WINDOW
T = TABLES

SIZES AND MEASUREMENTS ARE NOT RIGHT BUT LOCATIONS ARE. I NEVER SAW THE LOG HOUSE. THATS WHERE THEY TOLD ME IT WAS. JOHNNY AND DAD BORN IN LOG HOUSE, UNCLE CHARLEY IN NEW ONE. JUST BEFORE THEY SOLD THE FARM, THEY SOLD THE OTHER HOUSE AND IT WAS MOVED NORTH AND TWO MILES EAST. (ABOUT) AFTER UNCLE CHARLEY AND AUNT ESIE MOVED TO TOLEDO, OTHERS LIVED IN THE HOUSE AND DID THE FARMING.

FAMILY GROUP No. _____ **Husband's Full Name** FRED(E)RICK, John J.

This Information Obtained From:		Husband's Data	Day	Month	Year	City, Town or Place	County or Province, etc.	State or Country	Add. Info. on Husband
	Birth	16 Oct 1812						PA	
	Chr'nd								
	Mar.								
	Death	22 Jun 1881	Wauseon	Fulton		OH		68y8m6d	
	Burial		York Twp.	Fulton		OH		Zion Cem.	
Places of Residence									
Occupation									
Church Affiliation									
Military Rec.									
Other wives, if any, No. (1) (2) etc. Make separate sheet for each mar.									
His Father									
Mother's Maiden Name									
Wife's Full Maiden Name LEIST, Catharine									
	Birth	4 Nov 1815							
	Chr'nd								
	Death	15 Aug 1880	York Twp.	Fulton		OH		64y9m11d	
	Burial		York Twp.	Fulton		OH		Zion Cem.	
Compiler Isabelle Pursel									
Places of Residence									
Address 505 Brussel St.									
Occupation if other than Housewife									
Church Affiliation									
Other husbands, if any, No. (1) (2) etc. Make separate sheet for each mar.									
City, State Archbold, OH									
Date May, 1981									
Her Father George Leist									
Mother's Maiden Name Rebecca									

Form A1 Copyright 1983 by The Everton Publishing Co.
P.O. Box 318, EPHRAIM, PA 17822
GENEALOGICAL REFERENCE Send for a free catalogue with
lists and full descriptions of many genealogical aids

Sex	Children's Names in Full (Arrange in order of birth)	Children's Data	Day	Month	Year	City, Town or Place	County or Province, etc.	State or Country	Add. Info. on Child
1	Jacob Full Name of Spouse*	Birth					Pickaway	OH	
		Mar.							
	Susan J.	Death	1 Mar 1874						37y5m7d
		Burial				York Twp.	Fulton	OH	Zion Cem.
2	Elizabeth Full Name of Spouse*	Birth			1838				
		Mar.	13 Jan 1859						
	Roswell Skeels	Death			1917				
		Burial				York Twp.	Fulton	OH	Zion Cem.
3	Louisa Full Name of Spouse*	Birth							
		Mar.							
		Death	11 Mar 1861						18y9m8d
		Burial				York Twp.	Fulton	OH	Zion Cem.
4	John L. Full Name of Spouse*	Birth							
		Mar.							
		Death			1866				22y8m5d
		Burial				York Twp.	Fulton	OH	Zion Cem.
5	Ellen Full Name of Spouse*	Birth							
		Mar.							
	Sam Snyder	Death							
		Burial							
6	George Washington Full Name of Spouse*	Birth	13 Aug 1847						
		Mar.	27 Sep 1871						
		Death	24 Nov 1925						78y3m11d
	(1) Sarah Shinabarger	Burial				York Twp.	Fulton	OH	Zion Cem.
7	Elias Full Name of Spouse*	Birth							
		Mar.				See his family group sheet		p.3	
		Death							
	Mary Shoemaker	Burial							
8	Isaiah Full Name of Spouse*	Birth			1855	York Twp.	Fulton	OH	
		Mar.							
		Death	16 Jul 1924						
	Almeda Anspaugh	Burial				York Twp.	Fulton	OH	Zion Cem.
9		Birth							
		Mar.							
	Full Name of Spouse*	Death							
		Burial							
10		Birth							
		Mar.							
	Full Name of Spouse*	Death							
		Burial							

JOHN AND CATHARINE FRED(E)RICK

John Frederick was born 16 Oct 1812. (The 1850 Federal Census for York Twp. Fulton Co. OH lists his birthplace as PA. Tradition is that 6 Frederick brothers and/or cousins came from PA to another county(ies) in Ohio prior to coming to NW OH. On the 1870 and 1880 Federal Census reports, he is listed as John J. It is said that his nickname was Jack, and that his mother was a Valentine.

Catharine (Leist) Frederick was born 4 Nov 1815. (Her death record lists her place of birth as Pickaway, OH, and her parents as George and Rebecca Leist. The 1860 Census states she "cannot read or write".)

The early years of their marriage were probably spent in Pickaway Co. OH for that is the place of birth of their oldest son Jacob, according to his death record. In Fulton Co., they lived in Section 10 of York Twp., in the SE corner of the NW quarter, and prior to the forming of Fulton County in 1850, that would have been Henry Co. According to Census records, his real estate value in 1850 was \$250., in 1860 was \$600., and in 1870 was \$2500. They are buried in Zion Cemetery, York Twp. Fulton Co. OH near their children John, Elias, Jacob and Louisa. Their grave markers, and those of the above children, are with the spelling Fredrick, and the rest are with the spelling Frederick. Their stone has the following inscription under his name.

"Remember friends as you pass by As you are now so once was I.

As I am now you soon shall be. Prepare for death and follow me."
and under her name: "Blessed are the dead which die in the Lord."

Other known information than that which is on the John and Catharine Frederick family group sheet follows:

Jacob and his wife Susan are buried in Zion Cemetery. She died 23 Nov 1881, 49y 11m 2d.

Elizabeth (called Libbie) and Roswell Skeels (1836-1921) are buried in Zion Cemetery. They had a daughter Amelia who married an Overly. Gravestones list other children as Celia d. 24 Dec 1865, 5y 3m 4d, and Nelson D. d. 27 Dec 1864, 3m 3d.

Louisa's gravestone is inscribed:

"Dear aunt thou has left us, and thy loss we deeply feel,

But this God that hath bereft us, He can all our sorrows heal."

John L. was a Civil War soldier (GAR). His stone is inscribed:

"Son, thou art gone to rest, thine is an early tomb.

But Jesus summoned thee away, The Saviour called thee home.

Ellen and Sam Snyder had two daughters: Nettie who married Clem Orndorff, and Emma who married 28 Mar 1895 Fred Segrist.

The first wife of George, Sarah E. Shinabarger was born 28 Aug 1850 and died 17 Sep 1903 of typhoid fever. Their Children: A gravestone lists a Merty R. d 25 Oct 1872, 9m. George Sherman Frederick (14 Oct-1873-- 22 Nov 1937 m. (1) Nellie Skeels (1872-7 Apr 1910) and m. (2) 20 Mar 1913 Nettie Lutton (8 Mar 1885-3 Jan 1968). (Nettie later married Fred Segrist.) Martha Rozella (6 Sep 1875-5 Dec 1950) m. Francis Mohler (27 Sep 1874-20 May 1951). Nellie Frederick (1877-1903) married Mon Tabor and soon died of typhoid fever. Courthouse records a male child, no name, born to George and Sarah 24 Mar 1883. Florence Alta Frederick (11 Nov 1891-13 May 1955) m. 5 Mar 1911 Albert Kissell (24 Apr 1886-29 Mar 1964). A gravestone lists a child Lawrence. He died of typhoid fever, as his mother and sister did, probably in 1903. George m. (2) 17 Apr 1910 Hattie Malinda Lammon Salsberry (8 Feb 1859-15 Feb 1937), widow of David Jr. Salsberry. Most of this family are buried in Zion Cemetery, except the Mohlers who are in Young Cemetery in Liberty Center, OH.

Almeda (1858-1946), wife of Isaiah, is buried with him in Zion Cemetery.

Name of Compiler Isabelle Pursel

FOUR GENERATION ANCESTOR CHART

Address 505 Brussel St.Person No. 1 on this chart is the same
person as No. _____ on chart No. _____.

Chart No. _____

City, State Archbold, OHDate May, 1981

Form A-14. Copyright by The Everton Publishers, Inc., P.O. Box 506, Logan, Utah 84301, publishers of THE GENEALOGICAL HELPER. Send for a free catalogue with lists and full descriptions of many genealogical aids.

b. Date of Birth
p.b. Place of Birth
m. Date of Marriage
p.m. Place of Marriage
d. Date of Death
p.d. Place of Death

4 SHOEMAKER, Henry

(Father of No. 2)
b. 29 Mar 1793
p.b. Berks Co. PA
m. 1812
p.m. Berks Co. PA
d.
p.d. OH

2 SHOEMAKER, Henry B.

(Father of No. 1)
b. 9 Mar 1832
p.b. Fairfield Co. OH
m. 18 Jun 1854
p.m. Fairfield Co. OH
d. 14 May 1909
p.d. Wells Co. IN

5 BRAUCHER, Rebecca

(Mother of No. 2)
b.
p.b.
d.
p.d. OH

1 SHOEMAKER, Mary

b. 6 Aug 1860
p.b. Adams Co. IN
m. 27 Feb 1879
p.m. Reiffsburg, Wells Co. IN
d. 26 Nov 1942
p.d. Wauseon, Fulton Co. OH

6 PONTIUS, John

(Father of No. 3)
b. 1804
p.b. PA
m.
p.m.
d. 30 Mar 1859
p.d. Hartford Twp. Adams Co. IN

3 PONTIUS, Sarah

(Mother of No. 1)
b. 1834
p.b.
d. 6 Feb 1861
p.d. Adams Co. IN

7 CRITZ (CRITES) Julia Ann

(Mother of No. 3)
b. ca 1805
p.b.
d. 1 Mar 1859
p.d. Hartford Twp. Adams Co. IN

FREDRICK, Elias

Spouse of No. 1.
b. 31 Aug 1850
p.b. York Twp. Fulton Co. OH
d. 21 Aug 1921
p.d. Delta, Fulton Co. OH

8 SHOEMAKER, Jacob

(Father of No. 4.
Cont. on chart No. _____)
b. 10 Oct 1757
p.b.
m. 1777
p.m.
d. 12 Jul 1836
p.d.

9 REICHELDERFER, Magdalena

(Mother of No. 4.
Cont. on chart No. _____)
b. 1761
p.b.
d. 13 Jul 1844
p.d.

10

(Father of No. 5.
Cont. on chart No. _____)
b.
p.b.
m.
p.m.
d.
p.d.

11

(Mother of No. 5.
Cont. on chart No. _____)
b.
p.b.
d.
p.d.

12 PONTIUS, John George

(Father of No. 6.
Cont. on chart No. _____)
b. 1776
p.b.
m.
p.m.
d. 1841
p.d.

13 MOYER, Catharine

(Mother of No. 6.
Cont. on chart No. _____)
b.
p.b.
d.
p.d.

14

(Father of No. 7.
Cont. on chart No. _____)
b.
p.b.
m.
p.m.
d.
p.d.

15

(Mother of No. 7.
Cont. on chart No. _____)
b.
p.b.
d.
p.d.

Husband's Full Name SHOEMAKER, Henry B.

Husband's Date	Day	Month	Year	City, Town or Place	County or Province, etc.	State or Country	Add. Info. on Husband
Birth	9	Mar	1832		Fairfield	OH	
Chr'nd							
Mar.	18	Jun	1854	Tarlton	Fairfield	OH	
Death	14	May	1909	Reiffsburg	Wells	IN	
Burial				Stahl Cem. Reiffsburg	Wells	IN	

Other wives, if any. No. (1) (2) etc.
Make separate sheet for each mar.

His Father	Henry Shoemaker	Mother's Maiden Name	Rebecca Braucher
------------	-----------------	----------------------	------------------

Wife's Data	Day Month Year	City, Town or Place	County or Province, etc.	State or Country	Add. Info. on Wife
Birth	1833			OH	
Chr'd					
Death	6 Feb. 1861		Adams	IN	
Burial					

Church Affiliation

Other husbands, if any. No. (1) (2) etc.
Make separate sheet for each mat.

Mother's Maiden Name Julia Ann Critz

Sex	Children's Names in Full (Arrange in order of birth)	Children's Data	Day Month Year	City, Town or Place	County or Province, etc.	State or Country	Add. Info. on Child
1	George Franklin Full Name of Spouse*	Birth	29 Apr 1855	Fairfield	OH		
		Mar.					
		Death	10 Sep 1856				
		Burial					
2	Julia Ann (Julian) Full Name of Spouse*	Birth	3 Oct 1856				
		Mar.					
		Death	28 Mar 1930	Jay	IN		
	Henry Bair	Burial		Bryant	Jay	IN	
3	Daniel Full Name of Spouse*	Birth	9 Mar 1858	Adams	IN		
		Mar.					
		Death	13 Jul 1859	Adams	IN		
		Burial		Hartford Cem, Adams	IN		
4	Mary Full Name of Spouse*	Birth					
		Mar.		See her family group sheet	p.3		
		Death					
		Burial					
5	Full Name of Spouse*	Birth					
		Mar.					
		Death					
		Burial					
6	Full Name of Spouse*	Birth					
		Mar.					
		Death					
		Burial					
7	Full Name of Spouse*	Birth					
		Mar.					
		Death					
		Burial					
8	Full Name of Spouse*	Birth					
		Mar.					
		Death					
		Burial					
9	Full Name of Spouse*	Birth					
		Mar.					
		Death					
		Burial					
10	Full Name of Spouse*	Birth					
		Mar.					
		Death					
		Burial					

MCLAUGHLIN MEMORIAL PUBLIC
LIBRARY
ARCHBOLD, OHIO 43502 41,496

FAMILY GROUP No.

Husband's Full Name SHOEMAKER, Henry B. (cont'd)

10.

This Information Obtained From:

Husband's Data	Day	Month	Year	City, Town or Place	County or Province, etc.	State or Country	Add. Info. on Husband
Birth	9	Mar	1832		Fairfield	OH	
Chr'd							
Mar.	15	Aug	1861				
Death	14	May	1909	Reiffsburg	Wells	IN	
Burial				Stahl Cem, Reiffsburg	Wells	IN	

Places of Residence

Occupation

Church Affiliation

Military Rec.

Other wives, if any. No. (1) (2) etc.
Make separate sheet for each mar.

His Father Henry Shoemaker

Mother's Maiden Name Rebecca Braucher

Wife's Full Maiden Name VALENTINE, Barbara Alice

Wife's Data	Day	Month	Year	City, Town or Place	County or Province, etc.	State or Country	Add. Info. on Wife
Birth	13	May	1838		Pickaway	OH	
Chr'd							
Death	14	Aug	1921	Poneto		IN	
Burial				Stahl Cem, Reiffsburg	Wells	IN	

Compiler Isabelle Pursel

Places of Residence

Address 505 Brussel St.

Occupation if other than Housewife

Church Affiliation

City, State Archbold, OH

Other husbands, if any. No. (1) (2) etc.
Make separate sheet for each mar.

Date May, 1981

Her Father Samuel Valentine

Mother's Maiden Name Elizabeth

Sex	Children's Names in Full (Arrange in order of birth)	Children's Data	Day	Month	Year	City, Town or Place	County or Province, etc.	State or Country	Add. Info. on Childr
1	Charles W. Full Name of Spouse*	Birth	20	Aug	1862		Adams	IN	
	(1) Margaret Myers	Mar.	17	Dec	1887	Keystone		IN	
		Death	14	Apr	1954				
		Burial				Mt. Tabor Cem, Muncie		IN	
2	Levi Full Name of Spouse*	Birth			1864		Adams	IN	
		Mar.							
		Death	25	Feb	1865				10m 25d
		Burial				Hartford Cem, Adams		IN	
3	Samuel A. Full Name of Spouse*	Birth	6	Jan	1866		Adams	IN	
	Mary Viola Watt	Mar.	23	Oct	1900				
		Death	6	Nov	1946				
		Burial				Mt. Tabor Cem, Muncie		IN	
4	Virena E. (Vina) Full Name of Spouse*	Birth	27	Dec	1867		Adams	IN	
	Samuel Linn	Mar.	21	Jul	1888				
		Death							
		Burial							
5	Almeda Alice Full Name of Spouse*	Birth	5	Sep	1870		Adams	IN	
	(1) Seth Cobbum	Mar.	3	Nov	1888				
		Death	27	Apr	1947				
		Burial				Orlando		FL	
6	Emma Celesta Full Name of Spouse*	Birth	11	Jan	1874		Adams	IN	
	Roswell Johns	Mar.	28	Dec	1897				
		Death	7	Apr	1955				
		Burial				Stahl Cem, Reiffsburg Wells		IN	
7		Birth							
	Full Name of Spouse*	Mar.							
		Death							
		Burial							
8		Birth							
	Full Name of Spouse*	Mar.							
		Death							
		Burial							
9		Birth							
	Full Name of Spouse*	Mar.							
		Death							
		Burial							
10		Birth							
	Full Name of Spouse*	Mar.							
		Death							
		Burial							

HENRY B. SHOEMAKER - (1) SARAH PONTIUS
(2) BARBARA ALICE VALENTINE

Henry B. Shoemaker was born 9 Mar 1832 in Fairfield Co. OH near Stoutsville to Henry and Rebecca (Braucher) Shoemaker. His mother died when he was about 6 years old, and his father married a widower Sarah Rodamal. He was brought up in the German Lutheran Church and joined in early childhood. In 1861, he transferred his membership to the Methodist Church. He was drafted in the Civil War, and while home on a sick furlough, hired a substitute who served for him during the war.

Sarah Pontius was born in 1833 to John and Julia Critz Pontius. She was the 7th of 17 children. Henry B. Shoemaker and Sarah were married 18 June 1854 near Tarlton, OH. It is recorded on June 19 1854 in the Marriage Records of Pickaway Co. OH, Vol. 4, page 311. Their children were George Franklin (1855-56), Julia Ann (1856-1930), Daniel 1858-59 and Mary (1860-1942). In 1856 they moved to a farm 2 and 1/2 miles SE of Geneva, Hartford Twp. Adams Co. IN. Sarah died 6 Aug Feb. 1861, when Mary was about 6 month old. She and son Daniel are buried in Hartford Cemetery, Adams Co. IN.

Barbara Alice Valentine was born 13 May 1838 to Samuel and Elizabeth Valentine in Pickaway Co. OH. In 1850, she with her parents moved to Wells Co. IN near Reiffsburg. She was one of the charter members of Reiffsburg Methodist Church. Henry B. Shoemaker and Barbara were married 15 Aug 1861. Their children: Charles W. (1862-1954), Levi (1864-65) 10 m 25 d., Samuel A. (1866-1946), Virena E. (1867-19), Almeda Alice (1870-1947) and Emma Celesta (1874-1955). In 1877 the family moved to Wells Co. IN near Reiffsburg. Both were members of the Myers Chapel Methodist Church. He died 14 May 1909, 77y, at Reiffsburg, IN. His obituary says he was one of the most highly esteemed and most substantial of the aged residents of Wells County. Barbara died 14 Aug 1921, 83y 3m 1d in Poneta, IN. Both are buried in Stahl Cemetery near Reiffsburg IN.

Other information about this family, which is not on the family group sheet, follows:

Henry Bair, (husband of Julia Ann,) b 12 May 1852, d. 26 Jun 1935. Their children: Ernest b. 12 Feb 1879, d 12 Dec 1943, m. Ethel Michael. Burl b. 23 Feb. 1881, m. Mabel E. Ong. Charles b. 27 Sep, 1882, d 19 Dec 1961, m. May Lewis, Grace b. 11 Apr 1885, m. Wilson Buhner, Mary b. 24 Sep 1887, d. 6 June 1941, m. Anthony Glendening, Lulu b. 12 Nov, 1892, d. 21 Nov 1972, m. Jerome Dilts, Delmar b. 1 Aug 1896, m. Olga Fellabaum.

Margaret "Maggie" Myers, (first wife of Charles W.,) d. 6 Jul 1890, 24y 1m 11d. Daughter, Ethel, b. 10 Apr 1889, m. (1) Edson N. Cochran, m. (2) Hugh G. Maddox. Frances Edna Watt, (second wife of Charles W.,) b 10 Dec 1872, d 27 Jul 1943, m 21 Jun 1899. Children: Helen, born prematurely 21 Apr 1900, Ruth Justine b 4 Sep 1901, d. 1963, m. Robert K. Frank, John Henry b. 19 Dec 1904, d. 10 Jan 1908, Esther Alice, lived 25 hours, Harriette Madalene, b 5 Feb, 1907, d 8 Aug 1976, Emily Charlene, b. 5 Jul 1909, m. George S. Beery, Miriam Elizabeth b 1 Nov 1911, d. 1977. Edith (Neese) Theil, (third wife of Charles W.,) b. 5 Feb 1887, d Aug 1980, m. 18 Jul 1946.

Mary Viola Watt, (wife of Samuel A.,) b 23 Oct 1870, 16 Feb 1940. Children: Paul Watt, b. 16 Aug 1901, d. 14 May 1975, m. Agnes Rosina Atz. Helen Jane, b 16 Sep 1903, m. Gilbert H. Ayers. Children of Samuel and Vina Linn: Levi Brenton, b. 2 Mar 1889, d. 17 Jul 1922, m. Helen Hettisheimer, Henry, d. 13 mo. old., John, b. 7 Oct 1896 m. Louise Dick. Children of Seth and Alice Cobbum: Leona Dell b. 8 Dec 1889, m. Leon Ballin, Elsie Pearl, b 31 Mar 1892, d. 11 May 1974, m. Wilson LeChot. Alice m. (2) 22 Nov 1929 Lowell W. Johnson. Roswell Fleming Johns, (husband of Emma Celesta) b. 3 Oct 1868, d. 18 Dec 1961. Children: Earl Shoemaker, b. 29 Sept 1901, d. 13 Mar 1960, m. Elizabeth Shivers. Erma Ellen b. 17 Aug 1910, m. (1) Ernest Edwin Workman, m. (2) Gene Brister. Harold Henry, b. 1 Feb 1912, d. 14 Sep 1966, m. Elizabeth Jane Koons.

HENRY SHOEMAKER - (1) REBECCA BRAUCHER
(2) SARAH RODAMAL

Henry Shoemaker, son of Jacob and Magdalena Reichelderfer Shoemaker was born 29 May 1793. He was baptized in the New Bethel Church, Albany Twp., Berks Co. PA on 16 Jun 1793. In 1812 he married Rebecca Braucher in Berks Co. PA. The information concerning his children is from various sources, sometimes conflicting. Two sons, Jacob b. 12 Aug 1813 and Joseph b. 26 Jun 1815 were born in Berks Co. PA. Mary b. 17 Mar 1818, Magdalena, Samuel, Rebecca b. 1 Mar 1822, Susannah, and Henry B. b. 9 Mar 1832 were born in Fairfield Co. OH. Rebecca died when Henry B. was about 6 years old and on 22 Sep 1838 he married a widow Sarah Rodamal (or Rodamer). Their children were Elvina b. 19 Aug 1840, Eli b. 9 Aug 1847 and Manoaah b. 29 Mar 1849., all born in Fairfield Co. OH.

Jacob married Elizabeth Gehrett, Mary married Peter King, Rebecca married Henry King, Henry B. married (1) Sarah Pontius and (2) Barbara Valentine, Susan married (1) Bowers, (2) Henry Kirkwood, (3) Reuben Stout, Elvina married Jacob Huffman, Eli married Amana Hite, and Manoaah married Mary Amanda Huffman.

Henry died in Fairfield Co. OH in 1856. His will lists ten heirs: Henry B. Shoemaker, Jacob Shoemaker, Magdalena Morris, Mary King, Samuel Shoemaker, Elvina Shoemaker, Rebecca King, Susannah Bowers, Elias Shoemaker, a minor, and Manoaah Shoemaker, a minor. Henry B. was administrator of his father's estate. Henry and Rebecca are buried in the Spangler Pioneer Cemetery near Tarlton, OH and Sarah is buried in Zion Church Cemetery, Washington Twp. Pickaway Co. OH.

JACOB AND MAGDALENA SHOEMAKER

The parents of Jacob Shoemaker, house carpenter and joiner, have not been definitely established. His Revolutionary War pension papers, on file in the National Archives, Washington DC, state that he was born 10 Oct 1757, married Magdalena Reichelderfer, daughter of Heinrich and Maria-Latgaima nee Lebegutgin, in 1777, and died 12 Jul 1836. He is on the tax lists of Albany Twp. Berks Co. PA as early as 1779. In 1808 they bought a farm in Pickaway Co. OH and in 1819 bought land in Clear Creek Twp. Fairfield Co. OH. His will, on file at the Fairfield Co. courthouse, lists his wife Magdalena, and children Henry, Daniel, Magdalena, Catherine, Mary and Rebecca. Henry was executor of his estate. Christian and Jacob Jr. died young.

The pension application papers state that Jacob enlisted in the army of the United States in the year 1776, and served in the Battalion of Flying Camp from Berks Co. in the state of Pennsylvania as a private in the Company commanded by Captain Jacob Mauser in the Regiment commanded by Colonel Henry Haller, that he was discharged with said Battalion on the 29th day of February A.D. 1777, that he states that he was in the battle of Long Island, and that he resided in Berks Co. Pennsylvania when he entered the service. The pension was applied for on 27 Mar 1851 by the only children then living, Henry, about 60, Daniel R., about 55, and Rebecca Leist, age 46.

FAMILY GROUP No.

Husband's Full Name PONTIUS, John

13.

This Information Obtained From:

This Information Obtained From:	Husband's Data	Day	Month	Year	City, Town or Place	County or Province, etc.	State or Country	Add. Info. on Husband
	Birth			1804				
	Chr'nd							
	Mar.							
	Death	30	Mar	1859	Hartford Twp	Adams	IN	54y9m 6d
	Burial			1859	Hartford Cem.	Adams	IN	
	Places of Residence							
	Occupation				Church Affiliation	Military Rec.		
	Other wives, if any, No. (1) (2) etc. Make separate sheet for each mar.							
	His Father John George Pontius				Mother's Maiden Name Catherine Schlessman			

Wife's Full Maiden Name CRITZ (CRITES) Juliann

Wife's Data	Day	Month	Year	City, Town or Place	County or Province, etc.	State or Country	Add. Info. on Wife
Birth			ca 1805				
Chr'nd							
Death	1	Mar	1859	Hartford Twp	Adams	IN	53y4m
Burial			1859	Hartford Cem.	Adams	IN	

Compiler Isabelle Pursel

Address 505 Brussel St.

City, State Archbold, OH

Date May, 1981

Places of Residence

Occupation if other than Housewife

Church Affiliation

Other husbands, if any, No. (1) (2) etc.
Make separate sheet for each mar.

Her Father

Mother's Maiden Name

Form AL Copyright 1960 by The Everton Publishers, Inc.
 (See back cover for full details) This form is a free catalogue with
 lists and full descriptions of many genealogical aids

Sex	Children's Names in Full (Arrange in order of birth)	Children's Data	Day	Month	Year	City, Town or Place	County or Province, etc.	State or Country	Add. Info. on Child
1	Catherine Full Name of Spouse*	Birth	23	Feb	1826				
	Reuben Ornar	Mar.							
		Death	4	Nov	1858				32y8m12d
		Burial				Hartford Cem.	Adams	IN	
2	George Full Name of Spouse*	Birth	23	Feb	1827		Pickaway	OH	
	(1) Emily Shoemaker	Mar.	13	May	1850				
		Death	1	May	1910				83y2m9d
		Burial				Hartford Cem.	Adams	IN	
3	Mary Full Name of Spouse*	Birth			1828				
	Jacob M. Shoemaker	Mar.							
		Death	3	Jan	1861				
		Burial				Hartford Cem.	Adams	IN	32y4m8d
4	Sophia Full Name of Spouse*	Birth	27	Nov	1829				
	Charles Reicheldeffer	Mar.							
		Death	30	Oct	1898				68y11m3d
		Burial				Hartford Cem.	Adams	IN	
5	Julia Ann Full Name of Spouse*	Birth	15	Dec	1830				
	Spangler	Mar.							
		Death	15	May	1901				70y5m
		Burial				Hartford Cem.	Adams	IN	
6	Caroline Full Name of Spouse*	Birth			ca 1832				
	Edward Reed	Mar.	4	Mar	1855				
		Death	6	Jun	1865				32y9m6d
		Burial				Hartford Cem.	Adams	IN	
7	Sarah E. Full Name of Spouse*	Birth			1833				
	Henry B. Shoemaker	Mar.				See her family group sheet	p.9		
		Death							
		Burial							
8	Elizabeth Full Name of Spouse*	Birth	28	Mar	1834				
	Salem Glendenen	Mar.	20	Aug	1857				
		Death	23	Jun	1859				25y2m26d
		Burial				Hartford Cem.	Adams	IN	
9	Leah Full Name of Spouse*	Birth	3	Jan	1835				
	Alexander Bols	Mar.	14	Aug	1856				
		Death	12	May	1907				
		Burial				Hartford Cem.	Adams	IN	
10	Cont'd on next sheet	Birth							
		Mar.							

CHILDREN CONTINUATION SHEET for FAMILY GROUP No. ____

Form 411 Copyright 1943 by The Everton Publishers, Inc., P.O. Box 504, Logan, Utah. Publishers of THE GENEOLOGICAL HELPER. Send for a free catalogue with lists and full descriptions of many genealogical aids.

Husband's full name PONTIUS, JohnWife's full maiden name CRITZ, Juliann

Sex	Children's Names in Full (Arrange in order of birth)	Children's Data	Day	Month	Year	City, Town or Place	County or Province, etc.	State or Country	Add. Info. on Children
	No. <u>10</u>	Birth			1837				
	<u>Rachel</u>	Mar.	25	Dec	1859				
	Full Name of Spouse	Death			1921				
	(1) <u>John Glendening</u>	Burial							
	No. <u>11</u>	Birth	7	Jul	1838				
	<u>Melinda</u>	Mar.							
	Full Name of Spouse	Death	9	Nov	1856				
		Burial				Hartford Cem.	Adams	IN	18y4m2d
	No. <u>12</u>	Birth	2	Apr	1840				
	<u>Lydia</u>	Mar.	30	Jun	1861				
	Full Name of Spouse	Death	11	May	1920				
	<u>James Glendening</u>	Burial				Hartford Cem.	Adams	IN	
	No. <u>13</u>	Birth							
	<u>Infant</u>	Mar.							
	Full Name of Spouse	Death							
		Burial							
	No. <u>14</u>	Birth			1842				
	<u>Lucinda</u>	Mar.							
	Full Name of Spouse	Death			1846				
		Burial				Pickaway		OH	
	No. <u>15</u>	Birth	28	Sep	1843				
	<u>John</u>	Mar.	23	Oct	1865				
	Full Name of Spouse	Death			1935				
	(1) <u>Rosanna Martin</u>	Burial				Hartford Cem.	Adams	IN	
	No. <u>16</u>	Birth			1845				
	<u>Phoebe</u>	Mar.	9	Oct	1872				
	Full Name of Spouse	Death			1919				
	<u>John W. Watson</u>	Burial							
	No. <u>17</u>	Birth			1846				
	<u>Daniel</u>	Mar.	5	Jul	1868				
	Full Name of Spouse	Death	18	Mar	1879				
	<u>Ellen C. Martin</u>	Burial							
	No. ____	Birth							
		Mar.							
	Full Name of Spouse	Death							
		Burial							
	No. ____	Birth							
		Mar.							
	Full Name of Spouse	Death							
		Burial							
	No. ____	Birth							
		Mar.							
	Full Name of Spouse	Death							
		Burial							
	No. ____	Birth							
		Mar.							
	Full Name of Spouse	Death							
		Burial							
	No. ____	Birth							
		Mar.							
	Full Name of Spouse	Death							
		Burial							

JOHN AND JULIA ANN PONTIUS

John Pontius was born in 1804, son of Johannes George (John George) and Catherine (Moyer) Pontius. Julia Ann Critz (Crites) was born about 1805. The 1850 Federal Census for Salt Creek Twp. Pickaway Co. Ohio lists him as 46, born in Ohio and owned real estate valued at \$10,000. It lists her as 45 and unable to read or write. They moved to IN in 1854, settling on Section 25, Hartford Twp., Adams Co. where he had entered land as early as 1837, and owned 640 acres, mostly in that township. They had 17 children and 13 are listed on the 1850 census. Two had died and two were no longer at home. (They had at least 10 daughters in a row and if the child who died in infancy was a girl, then there were 12 daughters in a row.) John and Julia both died in March 1859, she on the 1st and he on the 30th. They are buried in the Hartford Cemetery, Adams Co. IN, where most of their children also are buried.

Other information than that on the family group sheet follows and was obtained from the Hartford Cemetery and Pontius family records.

Emily (Shoemaker), first wife of George Pontius, b 12 Jan 1832, d 3 Aug 1888, 56y 5m 9d.

Malinda (Clinger), second wife of George Pontius, d. 23 Feb 1892, 58y 8m 8d.

Charles Reichelderfer, husband of Sophia, d 5 Jan 1859 25y 6m 12d. The last name of her second husband was Bolds.

Edward Reed, husband of Caroline, b 29 Mar 1825, d. 18 Mar 1900, 74y 11m 19d.

Alexander Bolds, husband of Leah, 1830-1912.

John Glendening, husband of Rachel, d. 3 Mar 1878, 40 y 9m 9d. The last name of her second husband was Uptygraph, and of her third husband was Mason.

James Glendening, husband of Lydia, b 6 Jun 1837, d. 28 Feb 1923.

Rosanne (Martin) wife of John Pontius, 1844-1870. (He was living with wife Mattie in Ft. Wayne IN in 1932, according to a letter from him that year.)

John Watson, husband of Phoebe, d 30 Jul 1877, 68y 1m 9d.

Ellen C., wife of Daniel, 1846-1929.

PONTIUS ANCESTORS

The known history of the Pontius family begins at Diensweiler, a village in Birkenfeld District, State of Rheinland-Pfalz (also known as the Rhenish Palatinate) in Germany.

NICLAS (NICKEL) PONTIUS "Shepherd of Diensweiler", b. ca 1570, wife Margretha died 20 Mar 1632 at Diensweiler. The names of their seven children are recorded in the Evangelical Lutheran Church at Birkenfeld.

VELTEN PONTIUS "Shepherd of Diensweiler", 4th child of Niclas and Margretha, b. 26 Mar 1606, Diensweiler, d. 16 Apr 1685 Deinsweiler, m. 2 Aug 1631 Eva Kraus, 7 children. 2nd wife Margaretha.

HANS NICKEL PONTIUS "linenweaver at Elborn", 1st child of Velten and Eva, b 14 Jul 1632, Diensweiler, d. 6 Jan 1693 at Eborn, m (1) 2 Sep 1655 Margretha Anthonius b. 1631, d. 26 Jan 1674, 3 children; m (2) Anna Margratha Hoffman of Kusel, 5 children.

JOHANN PETER PONTIUS "Shepherd of Baumholder", 1st child of Hans Nickel and Anna Margratha, b 6 Feb 1685, Eborn, bur. 14 Nov 1736 Berlangenbach, Birkenfeld Dist., m. 17 Jan 1715 Anna Rosina Catherina Hauch, chr. 13 Jan 1694 Berlangenbach, died either en route to America or in America. 7 children. (3 came to America in 1738.)

NICHOLAS PONTIUS (Johann Nickel), 6th child of Johann Peter and Anna Rosina Catherina, b Alsace, chr. 24 Aug 1728, d Berks Co. PA, m. Anna Margaret Shuey, b. 1730 Switzerland, d. 1 Nov 1794, Berks Co. PA. 7 sons and 2 daughters. Nicholas, at the age of 10, came to America in 1738 with his brother Johannes, 20, and mother Rosina, and possibly sister Mary. It took about 30 days to go down the Rhine River to Rotterdam, then six weeks to cross the Atlantic. He arrived at the port of Philadelphia 9 Sept 1738 and settled in Bethel Twp. Berks Co. (then Lancaster Co.) PA.

DANIEL PONTIUS, 1st son of Nicholas and Anna Rosina Catherina, was born in 1757 in Berks Co. PA, d. in 1814 Berks Co. PA, wife Catharine Schlessman, 8 children.

JOHN GEORGE PONTIUS (1776-1841), 2nd son of Daniel and Catharine, d. Pickaway Co. OH, m. Catherine Moyer, 8 (?) children. (Usually listed as George.)

JOHN PONTIUS (1804-1859) one of two known sons of John George and Catherine. His family group sheet and page of other information are included in this book.

FAMILY GROUP No.

Husband's Full Name FREDRICK, Daniel Elias

This Information Obtained From:

Husband's Data	Day	Month	Year	City, Town or Place	County or Province, etc.	State or Country	Add. Info. on Husband
Birth	15	Jan	1883	York Twp.	Fulton Co.	OH	
Chr'nd							
Mar.	22	Jun	1905	Liberty Twp.	Henry Co.	OH	
Death	9	Aug	1959	Wauseon	Fulton Co.	OH	
Burial	12	Aug	1959	York Twp.	Fulton Co.	OH	Zion Cem.

Places of Residence

Occupation

Church Affiliation

Military Rec.

Other wives, if any, No. (1) (2) etc.
Make separate sheet for each mar.

His Father Elias Fredrick

Mother's Maiden Name Mary Shoemaker

Wife's Full Maiden Name CLAPP, Emily Eugenia

Wife's Data	Day	Month	Year	City, Town or Place	County or Province, etc.	State or Country	Add. Info. on Wife
Birth	19	Jul	1883	Liberty Twp.	Henry Co.	OH	
Chr'nd							
Death	19	Apr	1979	Archbold	Fulton Co.	OH	
Burial	21	Apr	1979	York Twp.	Fulton Co.	OH	Zion Cem.

Compiler Isabelle Pursel

Places of Residence

Address 505 Brussel St.

Occupation if other than Housewife

Church Affiliation

City, State Archbold, OH

Other husbands, if any, No. (1) (2) etc.
Make separate sheet for each mar.

Date May, 1981

Her Father Theodore G. Clapp

Mother's Maiden Name Mary E. Tanier

Sex	Children's Names in Full (Arrange in order of birth)	Children's Data	Day	Month	Year	City, Town or Place	County or Province, etc.	State or Country	Add. Info. on Childr
1	Emerson Melvin Full Name of Spouse*	Birth							
		Mar.				See his family group sheets	pp. 20-21		
		Death							
		Burial							
2	Lena Lovelle Full Name of Spouse*	Birth							
		Mar.				See her family group sheets	pp. 28-29		
		Death							
		Burial							
3	Mary Estella Full Name of Spouse*	Birth							
		Mar.				See her family group sheet	p. 30		
		Death							
		Burial							
4	Ruth Isabelle Full Name of Spouse*	Birth							
		Mar.				See her family group sheet	p.38		
		Death							
		Burial							
5	Full Name of Spouse*	Birth							
		Mar.							
		Death							
		Burial							
6	Full Name of Spouse*	Birth							
		Mar.							
		Death							
		Burial							
7	Full Name of Spouse*	Birth							
		Mar.							
		Death							
		Burial							
8	Full Name of Spouse*	Birth							
		Mar.							
		Death							
		Burial							
9	Full Name of Spouse*	Birth							
		Mar.							
		Death							
		Burial							
10	Full Name of Spouse*	Birth							
		Mar.							
		Death							
		Burial							

*If married more than once No. each mar. (1) (2) etc. and list in "Add. info. on children" column. Use reverse side for additional children, other notes, references or information.

DANIEL AND EUGENIA FREDRICK

Daniel Elias Fredrick, son of Elias and Mary Fredrick was born 15 Jan 1883 in a log cagin in York Twp. Section 2, Fulton Co. OH. The weather that night was like a blizzard. Isaiah, a younger brother of Elias, had gone to see his girl friend at Wauseon. Her mother thought the weather was too bad for him to ride home, so she hid his saddle. He went on home, about 9 miles, without it, and upon arriving home was asked to go to Liberty Center, about 6 miles, to get the doctor for the birth of his nephew. Daniel had a brother, John Henry, born in 1880, and a brother, Charles Roswell, born in 1887. A farm home was built at some time SW of the log house, and Dannie and Charlie grew to manhood in this new home with their parents. The two brothers went to the Enterprise School about 1 and 1/2 miles south of their home. Dannie quit school after the 7th grade so that he could work at home to help pay off the mortgage. The boys sometimes attended Sunday School at the Taylor M.E. Church, about 1 and 1/4 miles west of their home, then would run to go to church with their parents at Hebron Christian Union Church. Daniel was converted at a tent meeting in 1899 conducted by Rev. E. C. Mason at Andrews Corners, just south of his home. Later, Enterprise United Brethren Church was erected near there, and he was a member until about the time of his marriage when he joined the Victory Chapel United Brethren Church near Liberty Center, OH.

Emily Eugenia Clapp was born 19 Jul 1883 at the home of her parents, Theodore and Mary Clapp, in Liberty Twp. Henry Co. OH, about 2 miles northwest of Liberty Center, OH. She was the oldest of six children. Harry Lester, Charles Wells, John Tanier, Mary Anna "Mamie", and Lena May followed in 1885, 1886, 1889, 1890 and 1892 respectively. Mamie died at one month. Genie and her brothers and sister attended the Reed school about 1/2 mile north, and she went to Liberty High School through the second year, then started teaching country schools. In July 1901 she taught near Gerald, and the next three months she taught near Naomi at the Damman school. Both were among German Lutherans and the parents wanted their children to be taught more English. That winter she went back to high school. In the spring of 1902 she finished a term for another teacher at the Conley school. In the fall of 1902 and spring of 1903, she taught at the Zachrich school, about 6 miles SW of New Bavaria. She did not teach after her father's death in 1904. She was converted at a meeting in the home of Frank Wagoner in Nov. 1889, and was one of the charter members of Victory Chapel United Brethren Church, founded in 1900. Rev. C. L. Snyder was the pastor.

Daniel and Eugenia were married on 22 Jun 1905 at the home of her parents by Rev. Henry Houghtby. They started housekeeping in Chas. Snyder's new home about 3/4 mile south of his parents, on the west side of the road. Later they lived 1/2 mile east of Liberty Chapel United Brethren Church. Daniel was granted a quarterly conference license to preach for the United Brethren In Christ (Old Constitution) on 19 Sep 1908 at the Fountain United Brethren Church. He received the certificate of license by mail on 26 Sep 1908, the day their son Emerson Melvin was born. In March 1909 they moved to a farm near Raker, which they always called "the sand hill". In October of that year they had sale and moved to Waldron MI for his first pastorate at Waldron Circuit (Waldron, County Line, Alvordton and Union Churches).

Daniel received his annual conference license to preach in August 1910 at the Bethel United Brethren Church near Blissfield, MI. The fall of that year they moved to West California Corners, Branch Co. MI, called No God's Corners, where he served as pastor of Branch Mission (Algansee, East Ovid, West California, Hall's Corners, and at two school-houses, first Quimby, then Phillips). Lena Lovelle was born there 4 Sep 1911.

In the fall of 1913 they moved to Hudson IN to serve Steuben Circuit (Hudson, Hopewell, Helmer and Lake Valley). Mary Estella was born there 3 Jan 1916.

DANIEL AND EUGENIA FREDRICK, cont'd.

They moved to Stryker OH in the fall of 1916 to serve Stryker Circuit (Stryker, Lockport, Evansport, Tiffin River and Beaver Creek). Because of the poor condition of the parsonage, they bought a home a couple blocks west in 1918 where Ruth Isabelle was born 15 Oct 1918.

The following fall, 1919, he was assigned to Wauseon OH Circuit (Bethany, Victory Chapel and Enterprise) and he served one year. They lived in their home in Stryker till April 1920 when they moved to one purchased at the north end of Delta OH.

The fall of 1920 he was not assigned to a church. From Sept. 1921, he served Toledo Mission (Hebron) for 11 months, and usually commuted by trolley from Delta. Then for two years he was not assigned a church. In Delta he earned a living at numerous jobs: - mail carrier, had grocery and milk delivery routes, and worked for a lumber yard.

From Sept. to Nov. 1924, he substituted at Fayette OH Circuit (Fayette, Fountain, and Morenci MI) and was officially assigned there in Nov. After public sale in Dec., they moved from Delta to the parsonage in Fayette. The Morenci church closed in 1926. While serving Fayette Circuit, he attended Tri-State Bible Institute at Hillsdale every summer and received his diploma in July of 1929. He was ordained as a minister of the United Brethren Church 30 Aug 1929. In August 1930 he asked for no church assignment, rented a home in the north end of town for 4 months, and then bought one nearby to which they moved. In Fayette he drove a school bus, clerked in a grocery store and did some farming. In Jan. 1931 he began serving the Prattville MI Community Church. Emerson graduated from Fayette High School in 1928, and attended one year at Huntington College, Huntington, IN. Lovelle graduated from Fayette High School in 1930. Emerson was married in 1930.

The fall of 1931 he was assigned to Raisin Circuit (Zion and Bethel) near Blissfield MI, and he served there 3 years. The parsonage was at Victorsville near the Zion church. Lovelle graduated from Lenawee County Normal in 1932. Mary graduated from Blissfield High School in 1933 and Lenawee County Normal in 1934.

He served Delta OH Station (Traill Chapel) from Aug. 1934 to Aug. 1937. Mary was married in 1935. Isabelle graduated from Delta High School in 1936.

Wauseon Circuit (Bethany, Victory Chapel, and Inlet) was served from 1937-1942. The parsonage was at West Barre Corners, side of Bethany church. Isabelle graduated from Huntington College, Huntington, IN in 1938.

Monclova Circuit (Monclova and Crissey) was served from Aug. 1942 to 1945. Isabelle was married in 1943. Lovelle was married in 1944.

In the fall of 1945, Daniel and Eugenia moved to Metz Station (Mt. Pleasant) near Metz IN and served till 1947.

In Aug. 1947 they moved to Waldron MI Circuit (Waldron and Alvordton), and in the fall of 1950 he retired from preaching from the circuit where he first began serving in 1909.

They returned to Delta, moving into their home on Fernwood where his parents had lived. Always ready to preach, he served Victory Chapel as sub pastor under Monclova Circuit from 1952 to 1954, and as sub pastor under Delta Circuit from 1954 to 1956. He also tended a gas station at South Delta and worked at odd jobs.

In 1957, Daniel had a stroke and another one two years later, passing away at Detwiler Hospital in Wauseon 9 Aug 1959. His funeral was in Penrod Funeral Home in Delta with Rev. F. F. DeGroff and Rev. A. E. Moore officiating. Eugenia lived alone in the home till Nov. 1969 when she moved to a small house back of Isabelle in Archbold OH. In Sept. 1971, she had a stroke and from Nov. 1971 till Dec. of 1978 stayed with her four children. After several month's illness, she passed away at Fairlawn Haven Nursing Home in Archbold on 19 Apr 1979. Her funeral was in Short Funeral Home, Archbold, OH with Rev. Varion Thorp officiating, assisted by Rev. Frank Strine and Rev. Donol Fredrick.

FAMILY GROUP No. _____ Husband's Full Name **FREDRICK, Emerson Melvin**

This Information Obtained From: _____

Husband's Data	Day	Month	Year	City, Town or Place	County or Province, etc.	State or Country	Add. Info. on Husband
Birth	26	Sep	1908	Liberty Twp.	Henry Co.	OH	
Chr'nd							
Mar.	26	Dec	1930	Alvordton	Williams Co.	OH	
Death							
Burial							

Places of Residence

Occupation

Church Affiliation

Military Rec.

Other wives, if any, No. (1) (2) etc.

(2) Madelene (Hodson) Jensen

His Father Daniel E. Fredrick Mother's Maiden Name E. Eugenia Clapp

Wife's Full Maiden Name **RHOADES, Grace Viola**

Wife's Data	Day	Month	Year	City, Town or Place	County or Province, etc.	State or Country	Add. Info. on Wife
Birth	27	Feb	1911	Kunkle	Williams Co.	OH	
Chr'nd							
Death	19	Mar	1952	Elkhart	Elkhart Co.	IN	
Burial	22	Mar	1952	Pulaski (Shifler Cem.)	Williams	OH	

Compiler Isabelle Pursel

Places of Residence

Address 505 Brussel St.

Occupation if other than Housewife

Church Affiliation

City, State Archbold, OH

Other husbands, if any, No. (1) (2) etc.

Make separate sheet for each mar.

Date May, 1981

Her Father William Rhoades

Mother's Maiden Name Bertha Brooks

Sex	Children's Names in Full (Arrange in order of birth)	Children's Data	Day	Month	Year	City, Town or Place	County or Province, etc.	State or Country	Add. Info. on Child
1	Phyllis Jean Full Name of Spouse*	Birth							
		Mar.				See her family group sheet	p.22		
		Death							
		Burial							
2	Donol Paul Full Name of Spouse*	Birth							
		Mar.				See his family group sheet	p.26		
		Death							
		Burial							
3	Full Name of Spouse*	Birth							
		Mar.							
		Death							
		Burial							
4	Full Name of Spouse*	Birth							
		Mar.							
		Death							
		Burial							
5	Full Name of Spouse*	Birth							
		Mar.							
		Death							
		Burial							
6	Full Name of Spouse*	Birth							
		Mar.							
		Death							
		Burial							
7	Full Name of Spouse*	Birth							
		Mar.							
		Death							
		Burial							
8	Full Name of Spouse*	Birth							
		Mar.							
		Death							
		Burial							
9	Full Name of Spouse*	Birth							
		Mar.							
		Death							
		Burial							
10	Full Name of Spouse*	Birth							
		Mar.							
		Death							
		Burial							

*If married more than once No. each mar. (1) (2) etc. and list in "Add. info. on children" column. Use reverse side for additional children, other notes, references or information.

FAMILY GROUP No. _____ **Husband's Full Name** FREDRICK, Emerson Melvin (cont.)²¹

This Information Obtained From:	Husband's Data	Day	Month	Year	City, Town or Place	County or Province, etc.	State or Country	Add. Info. on Husband
	Birth	26	Sep	1908	Liberty Twp.	Henry	OH	
	Chr'nd							
	Mar.	4	Sep	1952	Lakeville	St. Joseph	IN	
	Death							
	Burial							

Places of Residence

Occupation _____ Church Affiliation _____ Military Rec. _____

Other wives, if any. No. (1) (2) etc. (1) Grace Viola Rhoades
Make separate sheet for each mar.

His Father Daniel E. Fredrick Mother's Maiden Name E. Eugenia Clapp

Wife's Full Maiden Name HODSON, Madelene Marcells

Wife's Data	Day	Month	Year	City, Town or Place	County or Province, etc.	State or Country	Add. Info. on Wife
Birth	21	Jun	1912	Amboy	Miami	IN	
Chr'nd							
Death							
Burial							

Compiler Isabelle Pursel

Places of Residence

Address 505 Brussel St. Occupation if other than Housewife _____ Church Affiliation _____

City, State Archbold, OH Other husbands, if any. No. (1) (2) etc. (1) Peter Jensen
Make separate sheet for each mar.

Date May, 1981 Her Father Robert O. Hodson Mother's Maiden Name Letitia Ray

Form A1. Copyright 1983 by The Everton Publishers, Inc.
P.O. Box 346, Logan, Utah. Publishers of "THE
GENEALOGICAL HELPER" send for a free catalogue with
this and full descriptions of many genealogical aids.

Sex	Children's Names in Full (Arrange in order of birth)	Children's Data	Day	Month	Year	City, Town or Place	County or Province, etc.	State or Country	Add. Info. on Child
1		Birth							
	Full Name of Spouse*	Mar.							
		Death							
		Burial							
2		Birth							
	Full Name of Spouse*	Mar.							
		Death							
		Burial							
		Her sons by previous marriage:							
	Full Name of Spouse*	Birth	12	Oct	1931	Robert Martin Jensen			
		Mar.	16	May	1959	Shelda Lea Kuneff	b. 1 Dec. 1935		
		Death				Children:			
		Burial				David Robert Jensen	b. 7 Jul 1960		
4		Birth				Susan Lea Jensen	b. 23 Jul 1963		
	Full Name of Spouse*	Mar.							
		Death							
		Burial							
5		Birth	24	Aug	1935	Larry Lee Jensen			
	Full Name of Spouse*	Mar.	17	Sep	1955	Carol Workman	b. 24 Dec. 1936		
		Death				Children:			
		Burial				Bruce Allen Jensen	b. 23 Mar 1957		
6		Birth				Brian Lee Jensen	b. 1 Oct 1959		
	Full Name of Spouse*	Mar.				Adam Dale Jensen	b. 12 Mar 1963		
		Death							
		Burial							
7		Birth	20	Jul	1939	James Richard Jensen			
	Full Name of Spouse*	Mar.	5	Sep	1959	Jeanne Carolin Bealer	b. 12 Dec 1937		
		Death				Children:			
		Burial				Martin Neil Jensen	b. 12 Mar 1962		
8		Birth				Sherry Sue Jensen	b. 30 Jul 1963		
	Full Name of Spouse*	Mar.				Daniel Mark Jensen	b. 11 Aug 1965		
		Death							
		Burial							
9		Birth							
	Full Name of Spouse*	Mar.							
		Death							
		Burial							
10		Birth							
	Full Name of Spouse*	Mar.							
		Death							
		Burial							

FAMILY GROUP No. _____ Husband's Full Name STRINE, Frank Jr.

This Information Obtained From: _____

Husband's Data	Day	Month	Year	City, Town or Place	County or Province, etc.	State or Country	Add. Info. on Husband
Birth	23	Mar	1925	Goshen	Elkhart	IN	
Chr'd							
Mar.	25	Mar	1951	Elkhart	Elkhart	IN	
Death							
Burial							

Places of Residence

Occupation

Church Affiliation

Military Rec.

Other wives, if any, No. (1) (2) etc.
Make separate sheet for each mar.

His Father Benjamin F. Strine Mother's Maiden Name Helen L. Ratliff

Wife's Full Maiden Name FREDRICK, Phyllis Jean

Wife's Data	Day	Month	Year	City, Town or Place	County or Province, etc.	State or Country	Add. Info. on Wife
Birth	18	Dec	1931	Ransom	Hillsdale Co.	MI	
Chr'd							
Death							
Burial							

Compiler Isabelle Pursel

Places of Residence

Address 505 Brussel St.

Occupation if other than Housewife

Church Affiliation

City, State Archbold, OH

Other husbands, if any, No. (1) (2) etc.
Make separate sheet for each mar.

Date May, 1981

Her Father Emerson M. Fredrick Mother's Maiden Name Grace V. Rhoades

Sex	Children's Names in Full (Arrange in order of birth)	Children's Data	Day	Month	Year	City, Town or Place	County or Province, etc.	State or Country	Add. Info. on Child
1	Devon Ray Full Name of Spouse*	Birth							
		Mar.				See his family group sheet	p.23		
		Death							
		Burial							
2	Bruce Emerson Full Name of Spouse*	Birth							
		Mar.				See his family group sheet	p.24		
		Death							
		Burial							
3	Madelynn Louise Full Name of Spouse*	Birth							
		Mar.				See her family group sheet	p.25		
		Death							
		Burial							
4	Donalynn Marie Full Name of Spouse*	Birth	22	Sep	1958	Elkhart	Elkhart	IN	
		Mar.							
		Death							
		Burial							
5	Full Name of Spouse*	Birth							
		Mar.							
		Death							
		Burial							
6	Full Name of Spouse*	Birth							
		Mar.							
		Death							
		Burial							
7	Full Name of Spouse*	Birth							
		Mar.							
		Death							
		Burial							
8	Full Name of Spouse*	Birth							
		Mar.							
		Death							
		Burial							
9	Full Name of Spouse*	Birth							
		Mar.							
		Death							
		Burial							
10	Full Name of Spouse*	Birth							
		Mar.							
		Death							
		Burial							

FAMILY GROUP No.

Husband's Full Name

STRINE, Devon Ray

This Information Obtained From:

Husband's Data	Day	Month	Year	City, Town or Place	County or Province, etc.	State or Country	Add. Info. on Husband
Birth	9	Feb	1952	Elkhart	Elkhart	IN	
Chr'nd							
Mar.	11	Aug	1973	Blissfield	Lenawee	MI	
Death							
Burial							

Places of Residence

Occupation

Church Affiliation

Military Rec.

Other wives, if any, No. (1) (2) etc.
Make separate sheet for each mar.

His Father Frank Jr. Strine

Mother's Maiden Name Phyllis Fredrick

Wife's Full Maiden Name

MALLORY, Kathy Diane

Wife's Data	Day	Month	Year	City, Town or Place	County or Province, etc.	State or Country	Add. Info. on Wife
Birth	27	Nov	1955	Adrian	Lenawee	MI	
Chr'nd							
Death							
Burial							

Compiler Isabelle Pursel

Places of Residence

Address 505 Brussel St.

Occupation if other than Housewife

Church Affiliation

City, State Archbold, OH

Other husbands, if any, No. (1) (2) etc.
Make separate sheet for each mar.

Date May, 1981

Her Father Emory E. Mallory

Mother's Maiden Name Betty B. Bailey

 Form M Copyright 1983 by The Everton Publishers, Inc.
 P.O. Box 500, Union Grove, WI 53188
 GENEALOGICAL HELPER Send for a free catalogue with
 lists and full descriptions of many genealogical aids.

Sex	Children's Names in Full (Arrange in order of birth)	Children's Data	Day	Month	Year	City, Town or Place	County or Province, etc.	State or Country	Add. Info. on Child
1	Kelly Kay Full Name of Spouse*	Birth	23	Feb	1975	Huntington	Huntington	IN	
		Mar.							
		Death							
		Burial							
2	April Dawn Full Name of Spouse*	Birth	22	Apr	1978	Goshen	Elkhart	IN	
		Mar.							
		Death							
		Burial							
3	Full Name of Spouse*	Birth							
		Mar.							
		Death							
		Burial							
4	Full Name of Spouse*	Birth							
		Mar.							
		Death							
		Burial							
5	Full Name of Spouse*	Birth							
		Mar.							
		Death							
		Burial							
6	Full Name of Spouse*	Birth							
		Mar.							
		Death							
		Burial							
7	Full Name of Spouse*	Birth							
		Mar.							
		Death							
		Burial							
8	Full Name of Spouse*	Birth							
		Mar.							
		Death							
		Burial							
9	Full Name of Spouse*	Birth							
		Mar.							
		Death							
		Burial							
10	Full Name of Spouse*	Birth							
		Mar.							
		Death							
		Burial							

* If married more than once, list each marriage and date to add info. on children. * If married more than once, list each marriage and date to add info. on children. * If married more than once, list each marriage and date to add info. on children.

FAMILY GROUP No.

Husband's Full Name STRINE, Bruce Emerson

24.

This Information Obtained From:

Husband's Data	Day	Month	Year	City, Town or Place	County or Province, etc.	State or Country	Add. Info. on Husband
Birth	14	Jan	1955	Elkhart	Elkhart	IN	
Chr'nd							
Mar.	15	Apr	1978	Waldbridge	Wood	OH	
Death							
Burial							

Places of Residence

Occupation

Church Affiliation

Military Rec.

Other wives, if any, No. (1) (2) etc.
Make separate sheet for each mar.

His Father Frank Jr. Strine Mother's Maiden Name Phyllis Fredrick

Wife's Full Maiden Name MOORE, Paulette Sue

Wife's Data	Day	Month	Year	City, Town or Place	County or Province, etc.	State or Country	Add. Info. on Wife
Birth	16	Mar	1955	Toledo	Lucas	OH	
Chr'nd							
Death							
Burial							

Compiler Isabelle Pursel

Places of Residence

Address 505 Brussel St.

Occupation if other than Housewife

Church Affiliation

City, State Archbold, OH

Other husbands, if any, No. (1) (2) etc.
Make separate sheet for each mar.

Date May, 1981

Her Father Robert E. Moore

Mother's Maiden Name Patricia J. Pelley

Sex	Children's Names in Full (Arrange in order of birth)	Children's Data	Day	Month	Year	City, Town or Place	County or Province, etc.	State or Country	Add. Info. on Child
1	Aimee Cherie Full Name of Spouse*	Birth	17	Mar	1979	Oregon	Lucas	OH	
		Mar.							
		Death							
		Burial							
2	Full Name of Spouse*	Birth							
		Mar.							
		Death							
		Burial							
3	Full Name of Spouse*	Birth							
		Mar.							
		Death							
		Burial							
4	Full Name of Spouse*	Birth							
		Mar.							
		Death							
		Burial							
5	Full Name of Spouse*	Birth							
		Mar.							
		Death							
		Burial							
6	Full Name of Spouse*	Birth							
		Mar.							
		Death							
		Burial							
7	Full Name of Spouse*	Birth							
		Mar.							
		Death							
		Burial							
8	Full Name of Spouse*	Birth							
		Mar.							
		Death							
		Burial							
9	Full Name of Spouse*	Birth							
		Mar.							
		Death							
		Burial							
10	Full Name of Spouse*	Birth							
		Mar.							
		Death							
		Burial							

*If married more than once No. each mar. (1) (2) etc. and list in "Add. info. on children" column. Use reverse side for additional children, other notes, references or information.

FAMILY GROUP No.

Husband's Full Name GRUBBS, Doye Britt

25.

This Information Obtained From:

Husband's Data	Day	Month	Year	City, Town or Place	County or Province, etc.	State or Country	Add. Info. on Husband
Birth	20	Dec.	1953	Cleveland	Bradley	TN	
Chr'nd							
Mar.	2	Sep	1978	Hillsdale	Hillsdale	MI	
Death							
Burial							

Places of Residence

Occupation

Church Affiliation

Military Rec.

Other wives, if any, No. (1) (2) etc.
Make separate sheet for each mar.

His Father Green J. Grubbs

Mother's Maiden Name Geraldine K.

Chastain

Wife's Full Maiden Name STRINE, Madelynn Louise

Wife's Data	Day	Month	Year	City, Town or Place	County or Province, etc.	State or Country	Add. Info. on Wife
Birth	25	Jul	1956	Elkhart	Elkhart	IN	
Chr'nd							
Death							
Burial							

Compiler Isabelle Pursel

Places of Residence

Address 505 Brussel St.

Occupation if other than Housewife

Church Affiliation

City, State Archbold, OH

Other husbands, if any, No. (1) (2) etc.
Make separate sheet for each mar.

Date May, 1981

Her Father Frank Jr. Strine

Mother's Maiden Name Phyllis Fredrick

Sex	Children's Names in Full (A: range in order of birth)	Children's Data	Day	Month	Year	City, Town or Place	County or Province, etc.	State or Country	Add. Info. on Child
1		Birth							
	Full Name of Spouse*	Mar.							
		Death							
		Burial							
2		Birth							
	Full Name of Spouse*	Mar.							
		Death							
		Burial							
3		Birth							
	Full Name of Spouse*	Mar.							
		Death							
		Burial							
4		Birth							
	Full Name of Spouse*	Mar.							
		Death							
		Burial							
5		Birth							
	Full Name of Spouse*	Mar.							
		Death							
		Burial							
6		Birth							
	Full Name of Spouse*	Mar.							
		Death							
		Burial							
7		Birth							
	Full Name of Spouse*	Mar.							
		Death							
		Burial							
8		Birth							
	Full Name of Spouse*	Mar.							
		Death							
		Burial							
9		Birth							
	Full Name of Spouse*	Mar.							
		Death							
		Burial							
10		Birth							
		Mar.							

FAMILY GROUP No. Husband's Full Name FREDRICK, Donol Paul

This Information Obtained From: Birth 14 Apr 1935 Syracuse Koskiosko IN

Chr'nd

Mar. 23 Dec 1954 Monroe Monroe MI

Death

Burial

Places of Residence

Occupation Church Affiliation Military Rec.

Other wives, if any, No. (1) (2) etc.

Make separate sheet for each mar.

His Father Emerson M. Fredrick Mother's Maiden Name Grace V. Rhoades

Wife's Full Maiden Name COX, Shirley Irene

Wife's Data Day Month Year City, Town or Place County or Province, etc. State or Country Add. Info. on Wife

Birth 14 May 1935 LaFollette Campbell TN

Chr'nd

Death

Burial

Places of Residence

Occupation if other than Housewife Church Affiliation

Other husbands, if any, No. (1) (2) etc.

Make separate sheet for each mar.

Her Father Sherman A. Cox Mother's Maiden Name Lula J. Sweat

Date May, 1981

Children's Names in Full Children's Data Day Month Year City, Town or Place County or Province, etc. State or Country Add. Info. on Child

Arrange in order of birth

Sex 1 Cheryl Ann Full Name of Spouse* Birth Mar. Death Burial See her family group sheet p.27

2 Gregory Paul Full Name of Spouse* Birth 5 Apr 1960 Wauseon Fulton OH

Mar. Death Burial

3 Full Name of Spouse* Birth Mar. Death Burial

4 Full Name of Spouse* Birth Mar. Death Burial

5 Full Name of Spouse* Birth Mar. Death Burial

6 Full Name of Spouse* Birth Mar. Death Burial

7 Full Name of Spouse* Birth Mar. Death Burial

8 Full Name of Spouse* Birth Mar. Death Burial

9 Full Name of Spouse* Birth Mar. Death Burial

10 Birth

FAMILY GROUP No. _____ **Husband's Full Name** HARTENSTEIN, David Lee

This Information Obtained From:	Husband's Date	Day	Month	Year	City, Town or Place	County or Province, etc.	State or Country	Add. Info. on Husband
Birth	29 Jul 1950	Dayton	Montgomery	OH				
Chr'd								
Mar.	17 May 1980	Dayton	Montgomery	OH				
Death								
Burial								
Places of Residence								
Occupation			Church Affiliation			Military Rec.		
Other wives, if any, No. (1) (2) etc. Make separate sheet for each mar.								
His Father Conrad J. Hartenstein Mother's Maiden Name Margaret Ushold								

Wife's Full Maiden Name FREDRICK, Cheryl Ann

Wife's Date	Day	Month	Year	City, Town or Place	County or Province, etc.	State or Country	Add. Info. on Wife
Birth	9 Aug 1957	Wauseon,	Fulton	OH			
Chr'd							
Death							
Burial							

Compiler Isabelle Pursel

Address 505 Brussel St.

City, State Archbold, OH

Date May, 1981

Children's Data	Day	Month	Year	City, Town or Place	County or Province, etc.	State or Country	Add. Info. on Child
Birth	5 Dec 1980	Dayton	Montgomery	OH			
Mar.							
Death							
Burial							

Occupation if other than Housewife

Church Affiliation

**Other husbands, if any, No. (1) (2) etc.
Make separate sheet for each mar.**

Her Father Donol P. Fredrick **Mother's Maiden Name** Shirley I. Cox

Sex	Children's Names in Full (Arrange in order of birth)	Children's Data	Day	Month	Year	City, Town or Place	County or Province, etc.	State or Country	Add. Info. on Child
1	David Ryan Full Name of Spouse*	Birth	5 Dec 1980	Dayton	Montgomery	OH			
		Mar.							
		Death							
		Burial							
2	Full Name of Spouse*	Birth							
		Mar.							
		Death							
		Burial							
3	Full Name of Spouse*	Birth							
		Mar.							
		Death							
		Burial							
4	Full Name of Spouse*	Birth							
		Mar.							
		Death							
		Burial							
5	Full Name of Spouse*	Birth							
		Mar.							
		Death							
		Burial							
6	Full Name of Spouse*	Birth							
		Mar.							
		Death							
		Burial							
7	Full Name of Spouse*	Birth							
		Mar.							
		Death							
		Burial							
8	Full Name of Spouse*	Birth							
		Mar.							
		Death							
		Burial							
9	Full Name of Spouse*	Birth							
		Mar.							
		Death							
		Burial							
10		Birth							

FAMILY GROUP No.

Husband's Full Name **REHBERG, Clyde Wesley**

This Information Obtained From:

Husband's Data	Day	Month	Year	City, Town or Place	County or Province, etc.	State or Country	Add. Info. on Husband
Birth	21	Jan	1915	London Twp.	Monroe	MI	
Chr'nd							
Mar.	26	Oct	1944	Monclova	Lucas	OH	
Death	9	May	1973	Ann Arbor	Washtenaw	MI	
Burial	12	May	1973	London (London Cem.)	Monroe	MI	
Places of Residence							
Occupation				Church Affiliation		Military Rec.	
Other wives, if any, No. (1) (2) etc. Make separate sheet for each mar.							
His Father Fred Rehberg				Mother's Maiden Name Mae Reid			

Wife's Full Maiden Name **FREDRICK, Lena Lovelle**

Wife's Data	Day	Month	Year	City, Town or Place	County or Province, etc.	State or Country	Add. Info. on Wife
Birth	4	Sep	1911		Branch	MI	
Chr'nd							
Death							
Burial							

Compiler **Isabelle Pursel**

Address **505 Brussel St.**

City, State **Archbold, Ohio**

Date **May, 1981**

Places of Residence							
Occupation if other than Housewife				Church Affiliation			
Other husbands, if any, No. (1) (2) etc. Make separate sheet for each mar. (2) Frank Kartje, Sr.							
Her Father Daniel E. Fredrick				Mother's Maiden Name E. Eugenia Clapp			

Form A1 Copyright 1983 by The Everton Publishers, Inc.
This form is published by permission of the
Genealogical Society of Utah. It is to be used with
lists and full descriptions of many genealogical aids.

Sex	Children's Names in Full (Arrange in order of birth)	Children's Data	Day	Month	Year	City, Town or Place	County or Province, etc.	State or Country	Add. Info. on Children
1		Birth							
	Full Name of Spouse*	Mar.							
		Death							
		Burial							
2		Birth							
	Full Name of Spouse*	Mar.							
		Death							
		Burial							
3		Birth							
	Full Name of Spouse*	Mar.							
		Death							
		Burial							
4		Birth							
	Full Name of Spouse*	Mar.							
		Death							
		Burial							
5		Birth							
	Full Name of Spouse*	Mar.							
		Death							
		Burial							
6		Birth							
	Full Name of Spouse*	Mar.							
		Death							
		Burial							
7		Birth							
	Full Name of Spouse*	Mar.							
		Death							
		Burial							
8		Birth							
	Full Name of Spouse*	Mar.							
		Death							
		Burial							
9		Birth							
	Full Name of Spouse*	Mar.							
		Death							
		Burial							
10		Birth							
	Full Name of Spouse*	Mar.							
		Death							
		Burial							

*If married more than once No. each mar. (1) (2) etc. and list in "Add. info. on children" column. Use reverse side for additional children, other notes, references or information.

FAMILY GROUP No. _____ Husband's Full Name KARTJE, Frank Sr.

This Information Obtained From:

Husband's Data	Day	Month	Year	City, Town or Place	County or Province, etc.	State or Country	Add. Info. on Husband
Birth	20	Dec	1907			Hungary	
Chr'nd							
Mar.	4	Oct	1980	Milan	Washtenaw	MI	
Death							
Burial							

Places of Residence

Occupation

Church Affiliation

Military Rec.

Other wives, if any, No. (1) (2) etc.

Make separate sheet for each mar.

(1) Helen Quackenboss (2) Bertha Throop Sheets

His Father Peter Kartje

Mother's Maiden Name Katalin Helfrich

Wife's Full Maiden Name FREDRICK, Lena Lovelle (cont'd.)

Wife's Data	Day	Month	Year	City, Town or Place	County or Province, etc.	State or Country	Add. Info. on Wife
Birth	4	Sep	1911		Branch	MI	
Chr'nd							
Death							
Burial							

Compiler Isabelle Pursel

Places of Residence

Address 505 Brussel St.

Occupation if other than Housewife

Church Affiliation

City, State Archbold, OH

Other husbands, if any, No. (1) (2) etc.

Make separate sheet for each mar.

(1) Clyde W. Rehberg

Date May, 1981

Her Father Daniel E. Fredrick

Mother's Maiden Name E. Eugenia Clapp

Sex	Children's Names in Full (Arrange in order of birth)	Children's Data	Day	Month	Year	City, Town or Place	County or Province, etc.	State or Country	Add. Info. on Children
1		Birth							
	Full Name of Spouse*	Mar.							
		Death							
		Burial							
2		Birth	12	Dec	1932	Frank J. Kartje, Jr.			
	Full Name of Spouse*	Mar.	22	Aug	1959	Lois Pauline Ortner	b. 2 Jul 1938		
		Death				Children:			
		Burial				Kirk Jay Kartje	b. 4 Aug 1962		
3		Birth				Kyle Jon Kartje	b. 14 Dec 1966		
	Full Name of Spouse*	Mar.				Kris Jai	b. 24 Mar 1968		
		Death							
		Burial							
4		Birth	12	Jun	1935	Duane Lee Kartje			
	Full Name of Spouse*	Mar.	10	Aug	1957	Jane Ann Broadhurst	b. 21 Oct 1938		
		Death				Children:			
		Burial				Mary Beth Kartje	b. 18 Nov 1958		
5		Birth				(Mar. Brian Patrick Finn)			
	Full Name of Spouse*	Mar.				Timothy Duane Kartje	b. 20 Feb 1960		
		Death							
		Burial							
6		Birth							
	Full Name of Spouse*	Mar.							
		Death							
		Burial							
7		Birth							
	Full Name of Spouse*	Mar.							
		Death							
		Burial							
8		Birth							
	Full Name of Spouse*	Mar.							
		Death							
		Burial							
9		Birth							
	Full Name of Spouse*	Mar.							
		Death							
		Burial							
10		Birth							
	Full Name of Spouse*	Mar.							
		Death							
		Burial							

*If married more than once No. each mar. (1) (2) etc. and list in "Add. info. on children" column. Use reverse side for additional children, other notes, references or information.

FAMILY GROUP No. _____ **Husband's Full Name** SAYLER, Melvin Philip

This Information Obtained From:	Husband's Date	Day Month Year	City, Town or Place	County or Province, etc.	State or Country	Add. Info. on Husband
	Birth	17 Aug 1914	Florence Twp.	Erie	OH	
	Chr'nd					
	Mar.	7 Jun 1935			IN	
	Death					
	Burial					

Places of Residence

Occupation _____

Church Affiliation _____

Military Rec. _____

Other wives, if any, No. (1) (2) etc.
Make separate sheet for each mar.His Father Milton John Sayler Mother's Maiden Name A. Elizabeth Alheit**Wife's Full Maiden Name** FREDRICK, Mary Estella

Wife's Date	Day Month Year	City, Town or Place	County or Province, etc.	State or Country	Add. Info. on Wife
Birth	3 Jan 1916	Hudson	Steuben	IN	
Chr'nd					
Death					
Burial					

Compiler Isabelle Pursel**Places of Residence**Address 505 Brussel St.

Occupation if other than Housewife _____

Church Affiliation _____

City, State Archbold, OHOther husbands, if any, No. (1) (2) etc.
Make separate sheet for each mar.Date May, 1981Her Father Daniel E. Fredrick Mother's Maiden Name E. Eugenia Clapp

Sex	Children's Names in Full (Arrange in order of birth)	Children's Date	Day Month Year	City, Town or Place	County or Province, etc.	State or Country	Add. Info. on Child
1	<u>Elwin Emerson</u> Full Name of Spouse*	Birth					
		Mar.		See his family group sheet	p. 31		
		Death					
		Burial					
2	<u>Norma Eileen</u> Full Name of Spouse*	Birth	2 Dec 1937	Florence Twp.	Erie	OH	
		Mar.					
		Death	19 Jun 1939	Florence Twp.	Erie	OH	
		Burial		Maple Grove Cem.	Erie	OH	
3	<u>Eleanor Mary</u> Full Name of Spouse*	Birth	25 Oct 1941	Elyria	Lorain	OH	
		Mar.					
		Death	2 Sep 1980	Lorain	Lorain	OH	
		Burial		Maple Grove Cem	Erie	OH	
4	<u>Galen Eugene</u> Full Name of Spouse*	Birth					
		Mar.		See his family group sheet	p.36		
		Death					
		Burial					
5	<u>Aileen Elizabeth</u> Full Name of Spouse*	Birth					
		Mar.		See her family group sheet	p.37		
		Death					
		Burial					
6	<u>Full Name of Spouse*</u>	Birth					
		Mar.					
		Death					
		Burial					
7	<u>Full Name of Spouse*</u>	Birth					
		Mar.					
		Death					
		Burial					
8	<u>Full Name of Spouse*</u>	Birth					
		Mar.					
		Death					
		Burial					
9	<u>Full Name of Spouse*</u>	Birth					
		Mar.					
		Death					
		Burial					
10	<u>Full Name of Spouse*</u>	Birth					
		Mar.					
		Death					

FAMILY GROUP No.

Husband's Full Name SAYLER, Elwin Emerson

31.

This Information Obtained From:

Husband's Data	Day	Month	Year	City, Town or Place	County or Province, etc.	State or Country	Add. Info. on Husband
Birth	30	Mar	1936	Florence Twp.	Erie	OH	
Chr'nd							
Mar.	7	Nov	1955	Florence Twp.	Erie	OH	
Death							
Burial							

Places of Residence

Occupation

Church Affiliation

Military Rec.

Other wives, if any. No. (1) (2) etc.
Make separate sheet for each mar.

His Father Melvin P. Sayler Mother's Maiden Name Mary E. Fredrick

Wife's Full Maiden Name HUNTER, Nancy Emma

Wife's Data	Day	Month	Year	City, Town or Place	County or Province, etc.	State or Country	Add. Info. on Wife
Birth	13	Feb	1939	Florence Twp.	Erie	OH	
Chr'nd							
Death							
Burial							

Compiler Isabelle Pursel

Places of Residence

Address 505 Brussel St.

Occupation if other than Housewife

Church Affiliation

City, State Archbold, OH

Other husbands, if any. No. (1) (2) etc.
Make separate sheet for each mar.

Date May, 1981

Her Father Merritt E. Hunter

Mother's Maiden Name Augusta M. Schoff

Sex	Children's Names in Full (Arrange in order of birth)	Children's Data	Day	Month	Year	City, Town or Place	County or Province, etc.	State or Country	Add. Info. on Child
1	Beth Ann Full Name of Spouse*	Birth							
		Mar.				See her family group sheet		p. 32	
		Death							
		Burial							
2	Christine Lovelle Full Name of Spouse*	Birth							
		Mar.				See her family group sheet		p.33	
		Death							
		Burial							
3	Orville Emerson Full Name of Spouse*	Birth							
		Mar.				See his family group sheet		p.34	
		Death							
		Burial							
4	Milton John Full Name of Spouse*	Birth							
		Mar.				See his family group sheet		p.35	
		Death							
		Burial							
5	Melvin Merritt Full Name of Spouse*	Birth	27	Jun	1963	Norwalk	Huron	OH	
		Mar.							
		Death							
		Burial							
6	Mary Augusta Full Name of Spouse*	Birth	16	Jul	1967	Norwalk	Huron	OH	
		Mar.							
		Death							
		Burial							
7	Sarah Nancy Full Name of Spouse*	Birth	17	Jun	1969	Sandusky	Erie	OH	
		Mar.							
		Death							
		Burial							
8	Full Name of Spouse*	Birth							
		Mar.							
		Death							
		Burial							
9	Full Name of Spouse*	Birth							
		Mar.							
		Death							
		Burial							
10	Full Name of Spouse*	Birth							
		Mar.							

FAMILY GROUP No. _____ Husband's Full Name PYCRAFT, Ronald Alan

This Information Obtained From: _____

Husband's Data	Day	Month	Year	City, Town or Place	County or Province, etc.	State or Country	Add. Info. on Husband
Birth	23	Sep	1955	Oberlin	Lorain	OH	
Chr'd							
Mar.	11	Dec	1976	Birmingham	Erie	OH	
Death							
Burial							

Places of Residence

Occupation

Church Affiliation

Military Rec.

Other wives, if any. No. (1) (2) etc.
Make separate sheet for each mar.

His Father Albert E. Pycraft Mother's Maiden Name Arlene R. Hurst

Wife's Full Maiden Name SAYLER, Beth Ann

Wife's Data	Day	Month	Year	City, Town or Place	County or Province, etc.	State or Country	Add. Info. on Wife
Birth	26	Mar	1956	Norwalk	Huron	OH	
Chr'd							
Death							
Burial							

Compiler Isabelle Pursel

Places of Residence

Address 505 Brussel St.

Occupation if other than Housewife

Church Affiliation

City, State Archbold, OH

Other husbands, if any. No. (1) (2) etc.
Make separate sheet for each mar.

Date May 1981

Her Father Elwin E. Sayler

Mother's Maiden Name Nancy E. Hunter

Children's Names in Full Arrange in order of birth	Children's Data	Day	Month	Year	City, Town or Place	County or Province, etc.	State or Country	Add. Info. on Child
1 Christopher Joel Full Name of Spouse*	Birth	26	Jan	1981	Columbus	Franklin	OH	
	Mar.							
	Death							
	Burial							
2 Full Name of Spouse*	Birth							
	Mar.							
	Death							
	Burial							
3 Full Name of Spouse*	Birth							
	Mar.							
	Death							
	Burial							
4 Full Name of Spouse*	Birth							
	Mar.							
	Death							
	Burial							
5 Full Name of Spouse*	Birth							
	Mar.							
	Death							
	Burial							
6 Full Name of Spouse*	Birth							
	Mar.							
	Death							
	Burial							
7 Full Name of Spouse*	Birth							
	Mar.							
	Death							
	Burial							
8 Full Name of Spouse*	Birth							
	Mar.							
	Death							
	Burial							
9 Full Name of Spouse*	Birth							
	Mar.							
	Death							
	Burial							
10	Birth							

FAMILY GROUP No.

Husband's Full Name MORRIS, Thomas Allen

This Information Obtained From:

Husband's Data	Day	Month	Year	City, Town or Place	County or Province, etc.	State or Country	Add. Info. on Husband
Birth	17	Jul	1953	Amherst	Lorain	OH	
Chr'd							
Mar.	7	Apr	1979	Birmingham	Erie	OH	
Death							
Burial							

Places of Residence

Occupation

Church Affiliation

Military Rec.

Other wives, if any. No. (1) (2) etc.
Make separate sheet for each mar.

His Father Thomas Lee A. Morris Mother's Maiden Name Donna McCullough

Wife's Full Maiden Name SAYLER, Christine Lovelle

Wife's Data	Day	Month	Year	City, Town or Place	County or Province, etc.	State or Country	Add. Info. on Wife
Birth	25	Dec	1957	Norwalk	Huron	OH	
Chr'd							
Death							
Burial							

Compiler Isabelle Pursel

Places of Residence

Address 505 Brussel St.

Occupation if other than Housewife

Church Affiliation

City, State Archbold, OH

Other husbands, if any. No. (1) (2) etc.
Make separate sheet for each mar.

Date May, 1981

Her Father Elwin M. Sayler

Mother's Maiden Name Nancy E. Hunter

Sex	Children's Names in Full (Arrange in order of birth)	Children's Data	Day	Month	Year	City, Town or Place	County or Province, etc.	State or Country	Add. Info. on Child
1		Birth							
	Full Name of Spouse*	Mar.							
		Death							
		Burial							
2		Birth							
	Full Name of Spouse*	Mar.							
		Death							
		Burial							
3		Birth							
	Full Name of Spouse*	Mar.							
		Death							
		Burial							
4		Birth							
	Full Name of Spouse*	Mar.							
		Death							
		Burial							
5		Birth							
	Full Name of Spouse*	Mar.							
		Death							
		Burial							
6		Birth							
	Full Name of Spouse*	Mar.							
		Death							
		Burial							
7		Birth							
	Full Name of Spouse*	Mar.							
		Death							
		Burial							
8		Birth							
	Full Name of Spouse*	Mar.							
		Death							
		Burial							
9		Birth							
	Full Name of Spouse*	Mar.							
		Death							
		Burial							
10		Birth							
	Full Name of Spouse*	Mar.							
		Death							
		Burial							

FAMILY GROUP No.

Husband's Full Name SAYLER, Orville Emerson

This Information Obtained From:

Husband's Data	Day	Month	Year	City, Town or Place	County or Province, etc.	State or Country	Add. Info. on Husband
Birth	26	Jun	1959	Norwalk	Huron	OH	
Chr'nd							
Mar.	20	Jan	1979	Florence Twp.	Erie	OH	
Death							
Burial							

Places of Residence

Occupation

Church Affiliation

Military Rec.

Other wives, if any, No. (1) (2) etc.
Make separate sheet for each mar.

His Father Elwin E. Sayler

Mother's Maiden Name Nancy E. Hunter

Wife's Full Maiden Name OSTHEIMER, Karen Danette

Wife's Data	Day	Month	Year	City, Town or Place	County or Province, etc.	State or Country	Add. Info. on Wife
Birth	11	Jun	1961	Sandusky	Erie	OH	
Chr'nd							
Death							
Burial							

Compiler Isabelle Pursel

Address 505 Brussel St.

City, State Archbold, OH

Date May, 1981

Places of Residence

Occupation if other than Housewife

Church Affiliation

Other husbands, if any, No. (1) (2) etc.
Make separate sheet for each mar.

Her Father Henry R. Ostheimer

Mother's Maiden Name Deanna M. Bunting

Sex	Children's Names in Full (Arrange in order of birth)	Children's Data	Day	Month	Year	City, Town or Place	County or Province, etc.	State or Country	Add. Info. on Children
1	Michael James Full Name of Spouse*	Birth	31	May	1979	Norwalk	Huron	OH	
		Mar.							
		Death							
		Burial							
2	Full Name of Spouse*	Birth							
		Mar.							
		Death							
		Burial							
3	Full Name of Spouse*	Birth							
		Mar.							
		Death							
		Burial							
4	Full Name of Spouse*	Birth							
		Mar.							
		Death							
		Burial							
5	Full Name of Spouse*	Birth							
		Mar.							
		Death							
		Burial							
6	Full Name of Spouse*	Birth							
		Mar.							
		Death							
		Burial							
7	Full Name of Spouse*	Birth							
		Mar.							
		Death							
		Burial							
8	Full Name of Spouse*	Birth							
		Mar.							
		Death							
		Burial							
9	Full Name of Spouse*	Birth							
		Mar.							
		Death							
		Burial							
10	Full Name of Spouse*	Birth							
		Mar.							
		Death							
		Burial							

*If married more than once No. each mar. (1) (2) etc. and list in "Add. info. on children" column. Use reverse side for additional children, other notes, references or information.

Husband's Data	Day	Month	Year	City, Town or Place	County or Province, etc.	State or Country	Add. Info. on Husband
Birth	4	Jun	1961	Norwalk	Huron	OH	
Chr'nd							
Mar.	6	Sep	1980	Milan	Erie	OH	
Death							
Burial							

His Father Elwin E. Saylor	Mother's Maiden Name Nancy E. Hunter
----------------------------	--------------------------------------

Wife's Data	Day Month Year	City, Town or Place	County or Province, etc.	State or Country	Add. Info. on Wife
Birth	16 May 1962	Norwalk	Huron	OH	
Chr'nd					
Death					
Burial					

Her Father Raymond D. Zimmerman Mother's Maiden Name Laura J. Holden

Sex	Children's Names in Full (Arrange in order of birth)	Children's Data	Day	Month	Year	City, Town or Place	County or Province, etc.	State or Country	Add. Info. on Child
1	Full Name of Spouse*	Birth							
		Mar.							
		Death							
		Burial							
2	Full Name of Spouse*	Birth							
		Mar.							
		Death							
		Burial							
3	Full Name of Spouse*	Birth							
		Mar.							
		Death							
		Burial							
4	Full Name of Spouse*	Birth							
		Mar.							
		Death							
		Burial							
5	Full Name of Spouse*	Birth							
		Mar.							
		Death							
		Burial							
6	Full Name of Spouse*	Birth							
		Mar.							
		Death							
		Burial							
7	Full Name of Spouse*	Birth							
		Mar.							
		Death							
		Burial							
8	Full Name of Spouse*	Birth							
		Mar.							
		Death							
		Burial							
9	Full Name of Spouse*	Birth							
		Mar.							
		Death							
		Burial							
10	Full Name of Spouse*	Birth							
		Mar.							
		Death							
		Burial							

FAMILY GROUP No.

Husband's Full Name

SAYLER, Galen Eugene

This Information Obtained From:

Husband's Data	Day	Month	Year	City, Town or Place	County or Province, etc.	State or Country	Add. Info. on Husband
Birth	2	Apr	1944	Elyria	Lorain	OH	
Chr'nd							
Mar.	3	Apr	1965	Florence Twp.	Erie	OH	
Death							
Burial							

Places of Residence

Occupation

Church Affiliation

Military Rec.

Other wives, if any. No. (1) (2) etc.
Make separate sheet for each mar.

His Father Melvin P. Sayler

Mother's Maiden Name Mary E. Fredrick

Wife's Full Maiden Name WENTZ, Susan Lynn

Wife's Data	Day	Month	Year	City, Town or Place	County or Province, etc.	State or Country	Add. Info. on Wife
Birth	7	Apr	1946	Berea	Cuyahoga	OH	
Chr'nd							
Death							
Burial							

Compiler Isabelle Pursel

Places of Residence

Address 505 Brussel St.

Occupation if other than Housewife

Church Affiliation

City, State Archbold, OH

Other husbands, if any. No. (1) (2) etc.
Make separate sheet for each mar.

Date May, 1981

Her Father Vernon A. Wentz

Mother's Maiden Name Emmogene E. Davis

 Form M Copyright 1983 by The Everton Publishers, Inc.
 P.O. Box 444, Independence, MO 64220
 GENEALOGICAL HELPER Send for a free catalogue with
 lists and full descriptions of many genealogical aids

Sex	Children's Names in Full (Arrange in order of birth)	Children's Data	Day	Month	Year	City, Town or Place	County or Province, etc.	State or Country	Add. Info. on Child
1	Gayle Lynne Full Name of Spouse*	Birth	18	Feb	1967	Norwalk	Huron	OH	
		Mar.							
		Death							
		Burial							
2	Daniel Everett Full Name of Spouse*	Birth	23	Sep	1969	Norwalk	Huron	OH	
		Mar.							
		Death							
		Burial							
3	Full Name of Spouse*	Birth							
		Mar.							
		Death							
		Burial							
4	Full Name of Spouse*	Birth							
		Mar.							
		Death							
		Burial							
5	Full Name of Spouse*	Birth							
		Mar.							
		Death							
		Burial							
6	Full Name of Spouse*	Birth							
		Mar.							
		Death							
		Burial							
7	Full Name of Spouse*	Birth							
		Mar.							
		Death							
		Burial							
8	Full Name of Spouse*	Birth							
		Mar.							
		Death							
		Burial							
9	Full Name of Spouse*	Birth							
		Mar.							
		Death							
		Burial							
10		Birth							
		Mar.							

FAMILY GROUP No. _____ **Husband's Full Name** CALABRESE, Frank Anthony (Tony) ^{37.}

This Information Obtained From: _____

Husband's Data	Day	Month	Year	City, Town or Place	County or Province, etc.	State or Country	Add. Info. on Husband
Birth	18	Jun	1946	Lorain	Lorain	OH	
Chr'd							
Mar.	7	Sep	1968	Vermillion	Erie	OH	
Death							
Burial							

Places of Residence

Occupation

Church Affiliation

Military Rec.

Other wives, if any. No. (1) (2) etc.
Make separate sheet for each mar.

His Father Frank Calabrese

Mother's Maiden Name Rosamond Brackett

Wife's Full Maiden Name SAYLER, Aileen Elizabeth

Wife's Data	Day	Month	Year	City, Town or Place	County or Province, etc.	State or Country	Add. Info. on Wife
Birth	2	Mar	1949	Norwalk	Huron	OH	
Chr'd							
Death							
Burial							

Compiler Isabelle Pursel

Places of Residence

Address 505 Brussel St.

Occupation if other than Housewife

Church Affiliation

City, State Archbold, OH

Other husbands, if any. No. (1) (2) etc.
Make separate sheet for each mar.

Date May, 1981

Her Father Melvin P. Sayler

Mother's Maiden Name Mary E. Fredrick

Sex	Children's Names in Full (Arrange in order of birth)	Children's Data	Day	Month	Year	City, Town or Place	County or Province, etc.	State or Country	Add. Info. on Child
1	Jennifer Aileen Full Name of Spouse*	Birth	7	Aug	1973	Lorain	Lorain	OH	
		Mar.							
		Death							
		Burial							
2	Anthony Frank Full Name of Spouse*	Birth	10	Nov	1977	Lorain	Lorain	OH	
		Mar.							
		Death							
		Burial							
3	Full Name of Spouse*	Birth							
		Mar.							
		Death							
		Burial							
4	Full Name of Spouse*	Birth							
		Mar.							
		Death							
		Burial							
5	Full Name of Spouse*	Birth							
		Mar.							
		Death							
		Burial							
6	Full Name of Spouse*	Birth							
		Mar.							
		Death							
		Burial							
7	Full Name of Spouse*	Birth							
		Mar.							
		Death							
		Burial							
8	Full Name of Spouse*	Birth							
		Mar.							
		Death							
		Burial							
9	Full Name of Spouse*	Birth							
		Mar.							
		Death							
		Burial							
10		Birth							
		Mar.							

FAMILY GROUP No.

Husband's Full Name PURSEL, Orville Dale

This Information Obtained From:

Husband's Data	Day	Month	Year	City, Town or Place	County or Province, etc.	State or Country	Add. Info. on Husband
Birth	23	Feb	1914	German Twp.	Fulton	OH	
Chr'nd							
Mar.	16	Jan	1943	Monclova (recorded in Fulton Co.)		OH	
Death							
Burial							

Places of Residence

Occupation

Church Affiliation

Military Rec.

Other wives, if any, No. (1) (2) etc.
Make separate sheet for each mar.

(1) Myrtle Grace Spiess

His Father Weldon V. Pursel

Mother's Maiden Name Lizzie Short

Wife's Full Maiden Name FREDRICK, Ruth Isabelle

Wife's Data	Day	Month	Year	City, Town or Place	County or Province, etc.	State or Country	Add. Info. on Wife
Birth	15	Oct	1918	Stryker	Williams	OH	
Chr'nd							
Death							
Burial							

Compiler Isabelle Pursel

Places of Residence

Address 505 Brussel St.

Occupation if other than Housewife

Church Affiliation

City, State Archbold, OH

Other husbands, if any, No. (1) (2) etc.
Make separate sheet for each mar.

Date May, 1981

Her Father Daniel E. Fredrick

Mother's Maiden Name E. Eugenia Clapp

Sex	Children's Names in Full (Arrange in order of birth)	Children's Data	Day	Month	Year	City, Town or Place	County or Province, etc.	State or Country	Add. Info. on Child
	Joseph Fredrick Full Name of Spouse*	Birth							
		Mar.				See his family group sheet p.39			
		Death							
		Burial							
2	Full Name of Spouse*	Birth							
		Mar.							
		Death							
		Burial				Orville's daughter by Myrtle			
3	Full Name of Spouse*	Birth	24	Aug	1939	Brenda Jean Pursel			
		Mar.	15	Aug	1964	Karl Albert Schleunes b.21 Apr 1937			
		Death				Children:			
		Burial				Anna Frederika Schleunes b. 30 May 1969			
4	Full Name of Spouse*	Birth							
		Mar.							
		Death							
		Burial							
5	Full Name of Spouse*	Birth							
		Mar.							
		Death							
		Burial							
6	Full Name of Spouse*	Birth							
		Mar.							
		Death							
		Burial							
7	Full Name of Spouse*	Birth							
		Mar.							
		Death							
		Burial							
8	Full Name of Spouse*	Birth							
		Mar.							
		Death							
		Burial							
9	Full Name of Spouse*	Birth							
		Mar.							
		Death							
		Burial							
10		Birth							
		Mar.							

FAMILY GROUP No. _____ Husband's Full Name PURSEL, Joseph Fredrick

This Information Obtained From:

Husband's Data	Day	Month	Year	City, Town or Place	County or Province, etc.	State or Country	Add. Info. on Husband
Birth	14	Oct	1952	Wauseon	Fulton	OH	
Chr'nd							
Mar.	14	Oct	1978	Archbold	Fulton	OH	
Death							
Burial							

Places of Residence

Occupation

Church Affiliation

Military Rec.

Other wives, if any, No. (1) (2) etc.
Make separate sheet for each mar.His Father Orville D. Purse Mother's Maiden Name Isabelle FredrickWife's Full Maiden Name MOHR, Paula Lynn

Wife's Data	Day	Month	Year	City, Town or Place	County or Province, etc.	State or Country	Add. Info. on Wife
Birth	5	May	1954	Wauseon	Fulton	OH	
Chr'nd							
Death							
Burial							

Compiler Isabelle Purse

Places of Residence

Address 505 Brussel St.

Occupation if other than Housewife

Church Affiliation

City, State Archbold, OHOther husbands, if any, No. (1) (2) etc.
Make separate sheet for each mar.Date May, 1981Her Father Ernest E. MohrMother's Maiden Name Esther Croninger

Sex	Children's Names in Full (Arrange in order of birth)	Children's Data	Day	Month	Year	City, Town or Place	County or Province, etc.	State or Country	Add. Info. on Child
1		Birth							
	Full Name of Spouse*	Mar.							
		Death							
		Burial							
2		Birth							
	Full Name of Spouse*	Mar.							
		Death							
		Burial							
3		Birth							
	Full Name of Spouse*	Mar.							
		Death							
		Burial							
4		Birth							
	Full Name of Spouse*	Mar.							
		Death							
		Burial							
5		Birth							
	Full Name of Spouse*	Mar.							
		Death							
		Burial							
6		Birth							
	Full Name of Spouse*	Mar.							
		Death							
		Burial							
7		Birth							
	Full Name of Spouse*	Mar.							
		Death							
		Burial							
8		Birth							
	Full Name of Spouse*	Mar.							
		Death							
		Burial							
9		Birth							
	Full Name of Spouse*	Mar.							
		Death							
		Burial							
10		Birth							
	Full Name of Spouse*	Mar.							
		Death							
		Burial							

MCLAUGHLIN MEMORIAL PUBLIC
LIBRARY

ARCHBOLD, OHIO 43502 91,996

*If married more than once No. each mar. (1) (2) etc. and list in "Add. info. on children" column. Use reverse side for additional children, other notes, references or information.

FAMILY GROUP No.

Husband's Full Name FREDRICK, Charles Roswell

This Information Obtained From:

Husband's Data	Day	Month	Year	City, Town or Place	County or Province, etc.	State or Country	Add. Info. on Husband
Birth	29	Sep	1887	York Twp.	Fulton	OH	
Chr'd							
Mar.	17	Dec	1911	Liberty Center	Henry	OH	
Death	11	Feb	1939	Toledo	Lucas	OH	
Burial			1939	Young Cem.	Liberty Center	OH	

Places of Residence

Occupation

Church Affiliation

Military Rec.

Other wives, if any. No. (1) (2) etc.
Make separate sheet for each mar.His Father Elias FredrickMother's Maiden Name Mary ShoemakerWife's Full Maiden Name HITE, Essie May

Wife's Data	Day	Month	Year	City, Town or Place	County or Province, etc.	State or Country	Add. Info. on Wife
Birth	17	Feb	1892	Liberty Twp.	Henry	OH	
Chr'd							
Death	9	Apr	1975	Toledo	Lucas	OH	
Burial	12	Apr	1975	Young Cem.	Liberty Center	OH	

Compiler Isabelle Pursel

Places of Residence

Address 505 Brussel St.

Occupation if other than Housewife

Church Affiliation

City, State Archbold, OHOther husbands, if any. No. (1) (2) etc.
Make separate sheet for each mar.Date May, 1981Her Father Noah F. HiteMother's Maiden Name Sarah J. Kershner

Sex	Children's Names in Full (Arrange in order of birth)	Children's Data	Day	Month	Year	City, Town or Place	County or Province, etc.	State or Country	Add. Info. on Children
1	<u>Lloyd Hite</u> Full Name of Spouse*	Birth							
		Mar.				See his family group sheet p. 42			
		Death							
		Burial							
2	<u>Walter Roswell</u> Full Name of Spouse*	Birth							
		Mar.				See his family group sheet p. 44			
		Death							
		Burial							
3	<u>Twila Almeda</u> Full Name of Spouse*	Birth	17	Feb	1918	Toledo	Lucas	OH	
		Mar.							
		Death	1	Mar	1918	Toledo	Lucas	OH	
		Burial				Young Cem.	Liberty Center	OH	
4	<u>Clarence Hubert</u> Full Name of Spouse*	Birth	7	Jan	1925	Toledo	Lucas	OH	
		Mar.							
		Death	31	Dec	1949	Toledo	Lucas	OH	
		Burial			1950	Young Cem.	Liberty Center	OH	
5	<u>Full Name of Spouse*</u>	Birth							
		Mar.							
		Death							
		Burial							
6	<u>Full Name of Spouse*</u>	Birth							
		Mar.							
		Death							
		Burial							
7	<u>Full Name of Spouse*</u>	Birth							
		Mar.							
		Death							
		Burial							
8	<u>Full Name of Spouse*</u>	Birth							
		Mar.							
		Death							
		Burial							
9	<u>Full Name of Spouse*</u>	Birth							
		Mar.							
		Death							
		Burial							
10	<u>Full Name of Spouse*</u>	Birth							
		Mar.							
		Death							
		Burial							

CHARLES AND ESSIE FREDRICK

Charles Roswell Fredrick, son of Elias and Mary Fredrick, was born 29 Sep 1887 in Section 2 of York Twp., Fulton Co. OH. Two brothers were born before he was born. They were John Henry and Daniel Elias. Charles attended the Enterprise country school, the Tayler M.E. Sunday School, and the Hebron Christian Union Church. He graduated from Delta High School in 1907 and then taught schools in the area for several years. One was the Swamp Angel school, and another was the Skeels school. Transportation was by "horse and buggy".

Essie May Hite was born 17 Feb 1892 in a log house. She was the youngest of two girls and three boys born to Noah Firdeman and Sarah Jane (Kerschner) Hite. The other children were Francis Marian, Mary Almeda, Harvey J. and Lester C. The original home of logs was located on the West side of the farm in Henry County, Liberty Twp. on Twp Rd. 9 and Co. Rd. V. The farm was a quarter section, 160 acres. Some time soon after Essie's birth, a new and larger home and barns were built on Co. Rd. V. This was a gravel road. Essie attended the Reed country school about a mile east of the homestead. She attended through the 6th grade. She was then needed to help with chores at home, and did live-in housework for some families in the area. The Hite family attended and were active in the Liberty Chapel United Brethren Church.

Charles and Essie were married 17 Dec 1911 at Liberty Center, OH. They lived in a house just South of the Elias Fredrick house, where Lloyd Hite was born 21 Nov 1913. In 1914 or 1915, they moved to Toledo, OH, corner of Fernwood Ave. and Upton Ave., where Walter Roswell was born 7 Mar 1916, and Twila Almeda on 17 Feb 1918. Twila died 1 Mar 1918. About 1920 or 1921, the family moved to 1401 Foster Ave., and this was close to Lincoln School where Lloyd and Walter first started school. Clarence Hubert was born at this address 7 Jan 1925. At age 2 and 1/2, Hubert contracted inflammation of the brain, and became blind. In 1928 the family moved to a new home at 4155 Commonwealth Ave. Lloyd graduated from Scott High School in 1932 and Walter from DeVilbiss High School in 1935. The family belonged to the Asbury M.E. Church, and then the Collingwood M.E. Church. Charles taught Sunday School for many years, first at Asbury, then at Collingwood. During his early years in Toledo, he taught night school at the Davis Business College. He was employed by the DeVilbiss Co. for years until his death Feb. 11 1939. His funeral was at the Boyer Van Wormer Funeral Home in Toledo.

Lloyd was married in 1939 and graduated from the Cleveland College of Embalming in 1946. He received licenses for Funeral Director and Embalmer in 1946 for the state of Ohio, and in 1981 for the state of Tennessee.

Hubert attended the Ohio State School for the Blind at Columbus, and he died of terminal tuberculosis 31 Dec. 1949.

Walter was married in 1941, and he died of a massive coronary attack in 1980.

Essie was employed as head housekeeper at Flower Hospital for several years. She remarried twice, - neither of which worked out. She lived alone and did her own house work until a few months before her death 9 Apr 1975. She had attended the Collingwood M.E. Church and been active in the women's organization. Her funeral was at the Walker-Feilbach Funeral Home in Toledo. Both parents are buried in Young Cemetery in Liberty Center, Henry Co. OH, with their children Hubert and Twila.

FAMILY GROUP No. _____ Husband's Full Name FREDRICK, Lloyd Hite

This Information Obtained From:	Husband's Data	Day	Month	Year	City, Town or Place	County or Province, etc.	State or Country	Add. Info. on Husband
	Birth	21	Nov	1913	York Twp	Fulton	OH	
	Chr'd							
	Mar.	27	May	1939	Toledo	Lucas	OH	
	Death							
	Burial							

Places of Residence

Occupation

Church Affiliation

Military Rec.

Other wives, if any, No. (1) (2) etc.
Make separate sheet for each mar.His Father Charles R. Fredrick Mother's Maiden Name Essie M. HiteWife's Full Maiden Name BEERY, Janet Elizabeth

Wife's Data	Day	Month	Year	City, Town or Place	County or Province, etc.	State or Country	Add. Info. on Wife
Birth	11	Sep	1913	Toledo	Lucas	OH	
Chr'd							
Death							
Burial							

Compiler Isabelle Pursel

Places of Residence

Address 505 Brussel St.

Occupation if other than Housewife

Church Affiliation

City, State Archbold, OHOther husbands, if any, No. (1) (2) etc.
Make separate sheet for each mar.Date May, 1981Her Father Rollo R. BeeryMother's Maiden Name Myrtle Texido
 Form A1 Copyright 1980 by The Everton Publishing, Inc.
 P.O. Box 518, Everton, MA 01939
 GENEALOGICAL HELPER Send for a free catalog with
 lists and full descriptions of many genealogical aids.

Sex	Children's Names in Full (Arrange in order of birth)	Children's Data	Day	Month	Year	City, Town or Place	County or Province, etc.	State or Country	Add. Info. on Child
1	<u>Ruth Anne</u> Full Name of Spouse*	Birth							
		Mar.				See her family group sheet	p. 43		
		Death							
		Burial							
2	<u>Full Name of Spouse*</u>	Birth							
		Mar.							
		Death							
		Burial							
3	<u>Full Name of Spouse*</u>	Birth							
		Mar.							
		Death							
		Burial							
4	<u>Full Name of Spouse*</u>	Birth							
		Mar.							
		Death							
		Burial							
5	<u>Full Name of Spouse*</u>	Birth							
		Mar.							
		Death							
		Burial							
6	<u>Full Name of Spouse*</u>	Birth							
		Mar.							
		Death							
		Burial							
7	<u>Full Name of Spouse*</u>	Birth							
		Mar.							
		Death							
		Burial							
8	<u>Full Name of Spouse*</u>	Birth							
		Mar.							
		Death							
		Burial							
9	<u>Full Name of Spouse*</u>	Birth							
		Mar.							
		Death							
		Burial							
10		Birth							
		Mar.							

FAMILY GROUP No. _____ Husband's Full Name BINDER, Robert Carl

This Information Obtained From: _____

Husband's Data	Day	Month	Year	City, Town or Place	County or Province, etc.	State or Country	Add. Info. on Husband
Birth	26	Feb	1939	Cleveland		OH	
Chr'nd							
Mar.	2	Jun	1962	Toledo	Lucas	OH	
Death							
Burial							

Places of Residence

Occupation

Church Affiliation

Military Rec.

Other wives, if any. No. (1) (2) etc.
Make separate sheet for each mar.His Father Martin C. Binder

Mother's Maiden Name

Wife's Full Maiden Name FREDRICK, Ruth Anne

Wife's Data	Day	Month	Year	City, Town or Place	County or Province, etc.	State or Country	Add. Info. on Wife
Birth	26	Jun	1940	Toledo	Lucas	OH	
Chr'nd							
Death							
Burial							

Compiler Isabelle Pursel

Places of Residence

Address 505 Brussel St.

Occupation if other than Housewife

Church Affiliation

City, State Archbold, OHOther husbands, if any. No. (1) (2) etc.
Make separate sheet for each mar.Date May, 1981Her Father Lloyd H. FredrickMother's Maiden Name Janet E. Beery

Sex	Children's Names in Full (Arrange in order of birth)	Children's Data	Day	Month	Year	City, Town or Place	County or Province, etc.	State or Country	Add. Info. on Childr
1	<u>Christopher John</u> Full Name of Spouse*	Birth	7	Aug	1967	Columbus	Franklin	OH	
		Mar.							
		Death							
		Burial							
2	<u>Full Name of Spouse*</u>	Birth							
		Mar.							
		Death							
		Burial							
3	<u>Full Name of Spouse*</u>	Birth							
		Mar.							
		Death							
		Burial							
4	<u>Full Name of Spouse*</u>	Birth							
		Mar.							
		Death							
		Burial							
5	<u>Full Name of Spouse*</u>	Birth							
		Mar.							
		Death							
		Burial							
6	<u>Full Name of Spouse*</u>	Birth							
		Mar.							
		Death							
		Burial							
7	<u>Full Name of Spouse*</u>	Birth							
		Mar.							
		Death							
		Burial							
8	<u>Full Name of Spouse*</u>	Birth							
		Mar.							
		Death							
		Burial							
9	<u>Full Name of Spouse*</u>	Birth							
		Mar.							
		Death							
		Burial							
10		Birth							

FAMILY GROUP No. _____ Husband's Full Name FREDRICK, Walter Roswell

This Information Obtained From:

Husband's Data	Day	Month	Year	City, Town or Place	County or Province, etc.	State or Country	Add. Info. on Husband
Birth	7	Mar	1916	Toledo	Lucas	OH	
Chr'nd							
Mar.	11	Oct	1941	Toledo	Lucas	OH	
Death	16	Apr	1980	Toledo	Lucas	OH	
Burial	19	Apr	1980				

Places of Residence

Occupation

Church Affiliation

Military Rec.

Other wives, if any. No. (1) (2) etc.
Make separate sheet for each mar.His Father Charles R. Fredrick Mother's Maiden Name Essie M. HiteWife's Full Maiden Name FOLSOM, Virginia Margaret

Wife's Data	Day	Month	Year	City, Town or Place	County or Province, etc.	State or Country	Add. Info. on Wife
Birth	28	Sep	1915	Toledo	Lucas	OH	
Chr'nd							
Death							
Burial							

Compiler Isabelle Pursel

Places of Residence

Address 505 Brussel St.

Occupation if other than Housewife

Church Affiliation

City, State Archbold, OHOther husbands, if any. No. (1) (2) etc.
Make separate sheet for each mar.Date May, 1981Her Father Warren H. FolsomMother's Maiden Name Cecilia Milhouse

Sex	Children's Names in Full (Arrang. in order of birth)	Children's Data	Day	Month	Year	City, Town or Place	County or Province, etc.	State or Country	Add. Info. on Child
1	<u>Walter Richard</u> Full Name of Spouse*	Birth							
		Mar.				See his family group sheet	p. 45		
		Death							
		Burial							
2	<u>Marcia Lynn</u> Full Name of Spouse*	Birth							
		Mar.				See her family group sheet	p. 46		
		Death							
		Burial							
3	<u>Robert Scott</u> Full Name of Spouse*	Birth	21	Nov	1957	Toledo	Lucas	OH	
		Mar.							
		Death							
		Burial							
4	<u>Full Name of Spouse*</u>	Birth							
		Mar.							
		Death							
		Burial							
5	<u>Full Name of Spouse*</u>	Birth							
		Mar.							
		Death							
		Burial							
6	<u>Full Name of Spouse*</u>	Birth							
		Mar.							
		Death							
		Burial							
7	<u>Full Name of Spouse*</u>	Birth							
		Mar.							
		Death							
		Burial							
8	<u>Full Name of Spouse*</u>	Birth							
		Mar.							
		Death							
		Burial							
9	<u>Full Name of Spouse*</u>	Birth							
		Mar.							
		Death							
		Burial							
10		Birth							
		Mar.							

FAMILY GROUP No.

Husband's Full Name FREDRICK, Walter Richard

45.

This Information Obtained From:

Husband's Data	Day	Month	Year	City, Town or Place	County or Province, etc.	State or Country	Add. Info. on Husband
Birth	9	Feb	1947	Toledo	Lucas	OH	
Chr nd							
Mar.	8	Aug	1969	Toledo	Lucas	OH	
Death							
Burial							

Places of Residence

Occupation

Church Affiliation

Military Rec.

Other wives, if any, No. (1) (2) etc.
Make separate sheet for each mar.His Father Walter R. Fredrick Mother's Maiden Name Virginia M. FolsomWife's Full Maiden Name MILLER, Darlene Margaret

Wife's Data	Day	Month	Year	City, Town or Place	County or Province, etc.	State or Country	Add. Info. on Wife
Birth	2	Mar	1947	Toledo	Lucas	OH	
Chr nd							
Death							
Burial							

Compiler Isabelle Pursel

Places of Residence

Address 505 Brussel St.

Occupation if other than Housewife

Church Affiliation

City, State Archbold, OhOther husbands, if any, No. (1) (2) etc.
Make separate sheet for each mar.Date May, 1981Her Father Thurmann G. MillerMother's Maiden Name Marian B. Malohn

Sex	Children's Names in Full (Arrange in order of birth)	Children's Data	Day	Month	Year	City, Town or Place	County or Province, etc.	State or Country	Add. Info. on Child
1	<u>Jennifer Sue</u> Full Name of Spouse*	Birth	29	Jul	1978	Toledo	Lucas	OH	
		Mar.							
		Death							
		Burial							
2	<u>Full Name of Spouse*</u>	Birth							
		Mar.							
		Death							
		Burial							
3	<u>Full Name of Spouse*</u>	Birth							
		Mar.							
		Death							
		Burial							
4	<u>Full Name of Spouse*</u>	Birth							
		Mar.							
		Death							
		Burial							
5	<u>Full Name of Spouse*</u>	Birth							
		Mar.							
		Death							
		Burial							
6	<u>Full Name of Spouse*</u>	Birth							
		Mar.							
		Death							
		Burial							
7	<u>Full Name of Spouse*</u>	Birth							
		Mar.							
		Death							
		Burial							
8	<u>Full Name of Spouse*</u>	Birth							
		Mar.							
		Death							
		Burial							
9	<u>Full Name of Spouse*</u>	Birth							
		Mar.							
		Death							
		Burial							
10	<u>Full Name of Spouse*</u>	Birth							
		Mar.							
		Death							
		Burial							

*If married more than once No. each mar. (1) (2) etc. and list in "Add. info. on children" column. Use reverse side for additional children, other notes, references or information.

FAMILY GROUP No.

Husband's Full Name LANDRY, Peter Michael

46.

This Information Obtained From:

Husband's Data	Day	Month	Year	City, Town or Place	County or Province, etc.	State or Country	Add. Info. on Husband
Birth	18	Nov	1950	Royal Oak	Oakland	MI	
Chr'nd							
Mar.	28	Nov	1975	Toledo	Lucas	OH	
Death							
Burial							

Places of Residence

Occupation

Church Affiliation

Military Rec.

Other wives, if any, No. (1) (2) etc.
Make separate sheet for each mar.

His Father George I. Landry Mother's Maiden Name Rosemary Kennedy

Wife's Full Maiden Name FREDRICK, Marcia Lynn

Wife's Data	Day	Month	Year	City, Town or Place	County or Province, etc.	State or Country	Add. Info. on Wife
Birth	13	Mar	1950	Toledo	Lucas	OH	
Chr'nd							
Death							
Burial							

Compiler Isabelle Pursel

Places of Residence

Address 505 Brussel St.

Occupation if other than Housewife

Church Affiliation

City, State Archbold, OH

Other husbands, if any, No. (1) (2) etc.
Make separate sheet for each mar.

Date May, 1981

Her Father Walter R. Fredrick Mother's Maiden Name Virginia M. Folsom

Form AL Copyright 1983 by The Family Publisher, Inc.
P.O. Box 346 Logan, Utah 84301
GENEALOGICAL HELPER Send for a free catalogue with
lists and full descriptions of many genealogical aids.

Sex	Children's Names in Full (Arrange in order of birth)	Children's Data	Day	Month	Year	City, Town or Place	County or Province, etc.	State or Country	Add. Info. on Child
1	Peter Erik Full Name of Spouse*	Birth	17	Dec	1976	Knoxville	Knox	TN	
		Mar.							
		Death	18	Dec	1976	Knoxville	Knox	TN	
		Burial							
2	Laura MyLynn Full Name of Spouse*	Birth	18	Jan	1978	Knoxville	Knox	TN	
		Mar.							
		Death							
		Burial							
3	Karon Jacquelyn Full Name of Spouse*	Birth	8	Sep	1979	Farmington	Wayne	MI	
		Mar.							
		Death							
		Burial							
4	Full Name of Spouse*	Birth							
		Mar.							
		Death							
		Burial							
5	Full Name of Spouse*	Birth							
		Mar.							
		Death							
		Burial							
6	Full Name of Spouse*	Birth							
		Mar.							
		Death							
		Burial							
7	Full Name of Spouse*	Birth							
		Mar.							
		Death							
		Burial							
8	Full Name of Spouse*	Birth							
		Mar.							
		Death							
		Burial							
9	Full Name of Spouse*	Birth							
		Mar.							
		Death							
		Burial							
10	Full Name of Spouse*	Birth							
		Mar.							
		Death							
		Burial							